

Scan QR Code to Watch Installation Video

Thank you for purchasing a National Cycle product. Read these instructions carefully and thoroughly before beginning work. Dealers, if installing this product for a customer, please give them this manual upon completion. It contains information needed to properly maintain and use this product.

Description:	Luggage Rack	Model:	2021-Current Honda® CMX1100 Rebel
Part Number:	P9502-002	Installation Time:	15-20 min.

P9502-002 PARTS LIST

ITEM	PART NO.	DESCRIPTION	QUANTITY
A	37-374661-000	Luggage Rack, Black	1
BAG#1344			
B	34-345559-000	Angled Bushing, Black	1
C	51-515709-000	Hex Socket Cap Screw, M8x10, Stainless	1
D	51-516150-000	Hex Socket Buttonhead Cap Screw, 5/8-18x1/4, Black	1

TOOLS REQUIRED FOR ASSEMBLY

5mm Allen Wrench 6mm Allen Wrench

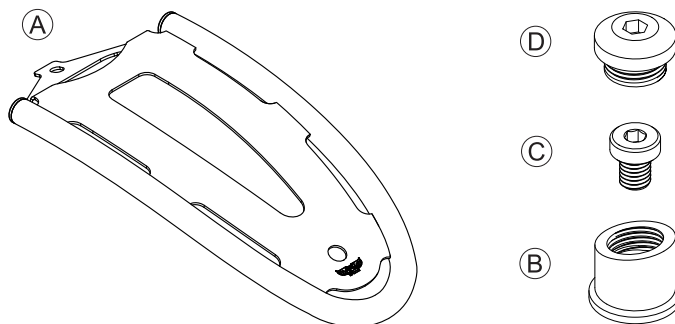

ATTENTION: Special notes and cautionary measures which can prevent damage to the accessory or vehicle.



NOTE: Tips for facilitation of operation, control and adjustment, as well as maintenance work.

PREPARATION

Carefully unpack your new accessory, sort the parts, and make sure you have everything required to complete the assembly. Park your bike on its sidestand with plenty of room to work around the rear end. Remove the motorcycle's seat.

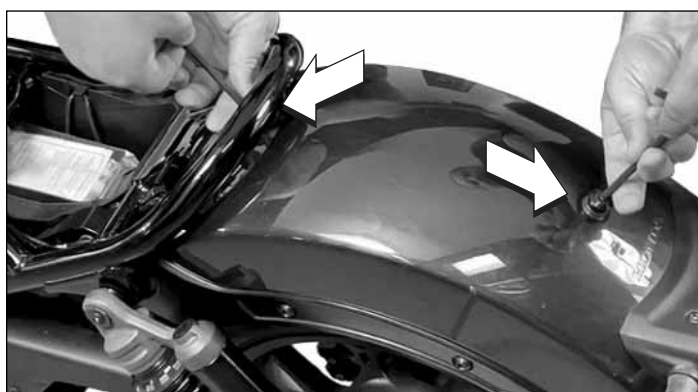

Step 1

INSTALLATION

Step 1

Using a 6mm Hex Wrench, remove the screw and spacer just forward of the seat rail. The spacer will not be reused, but save the screw for later reinstallation.

Remove the screw and spacer on the fender near the taillight. These pieces will not be reused.

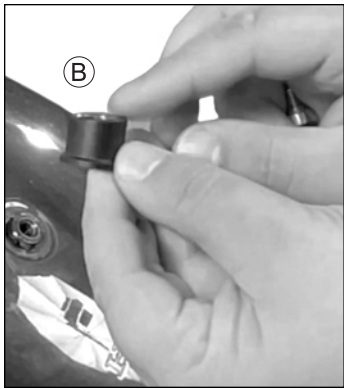

Step 2



Step 3



Step 4



Step 5

INSTALLATION; CONT'D

Step 2

The Luggage Rack's hardware kit contains an Angled Bushing (B) that will be secured to the fender with an M8x10 Stainless Hex Socket Cap Screw (C).



NOTE: The top of the Angled Bushing has a distinct slope. The shorter side faces forward toward the front of the bike when placed on the fender.

Step 3

Place the Angled Bushing (B) over the threaded stud on the rear fender (shorter side facing front) and insert the M8x10 Stainless Hex Socket Cap Screw (C) through the top. Secure with a 5mm Hex Wrench.



NOTE: Do not fully tighten yet. Later adjustment may be required.

Step 4

Now place the Luggage Rack (A) in position with the forward tab going under the seat rail and the tab's slotted hole aligning to the point on the bike where you removed the screw and spacer in Step 01.

Step 5

Using the OEM screw you removed from this point on the bike in Step 01, secure the mounting tab of the Luggage Rack to the bike, but only finger-tight right now.

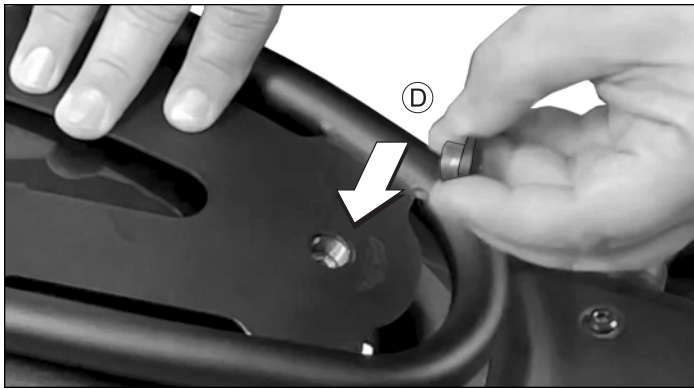

Step 6



Step 7



Step 8

INSTALLATION; CONT'D

Step 6

Reposition the rear of the Luggage Rack until the Rack's mounting hole lines up with the Angled Bushing (B).

If alignment is satisfactory, fully tighten the M8x10 Stainless Hex Socket Cap Screw (C) inside the Angled Bushing with a 5mm Hex Wrench.

Now secure the rack to the Angled Bushing with the Hex Socket Buttonhead Cap Screw (D).

Step 7

Using a 6mm Hex Wrench, fully tighten the OEM screw just forward of the seat rail that secures the Luggage Rack's mounting tab.

Now fully tighten the Hex Socket Buttonhead Cap Screw (D) at the rear of the rack.

Step 8

Align the seat's rear mounting points to their correct position on the bike, and then press down on the front of the seat until it clicks.

Installation is now complete. Ride safe and enjoy your new National Cycle Luggage Rack!

WARNING

Never operate your vehicle with loose accessory mounting hardware. Check the hardware for tightness regularly.

Motorcycles are built with enough frame rigidity to withstand the moderate loads imposed on them by the foreseeable addition of an accessory(ies). If an accessory(ies) adversely affects your vehicle's stability, immediately remove the accessory(ies). Do not operate a vehicle that exhibits unsafe handling traits.

Have experienced service personnel correct any problem before driving with the accessory(ies) installed. For further questions concerning handling problems associated with an accessory(ies), contact your dealer, motorcycle manufacturer, or accessory manufacturer.

Load capacity: 10 lbs. (4.5kg). Do not exceed limits.

Do not block taillight or brake light with your gear or luggage.

