

071921 Honda NT1100 Hugger Fitting Instructions

Kit Includes:

1X	C071921	Moulding
1X	CFK071921	Bracket - right-hand side
1X	CFK071921A	Bracket - left-hand side
5X	CBOL0251	M6 x 16mm Bolt
5X	CWAS0221	M6 Washer
1X	CRUB0010	Rubber Strip (120mm length)
1X	CBOL0017 <small>Pre-fitted by Pyramid</small>	M4 x 12mm Bolt
2X	CNUT0215 <small>Pre-fitted by Pyramid</small>	Aluminium Nut

Fitting note: attach fixings loosely at first - this aids alignment of the hole centres.

Remove the original chainguard. Remove the brake hose clip on the right hand side of the swingarm (retain the OEM posi-drive bolt from this mounting point).

Attach the rubber strip to the left-hand side bracket as shown below in **Fig 1**.

Attach the right-hand side bracket to the hugger as shown in **Fig 2**.

Fit the hugger to the bike as shown in **Fig 2 & 3**.

Fig 4 shows how the right-hand side bracket needs to be positioned to support the hugger once tightened - we advise the use of thread-locking fluid on this bolt.

Fully tighten all mounting points. Ensure fixings are checked periodically.

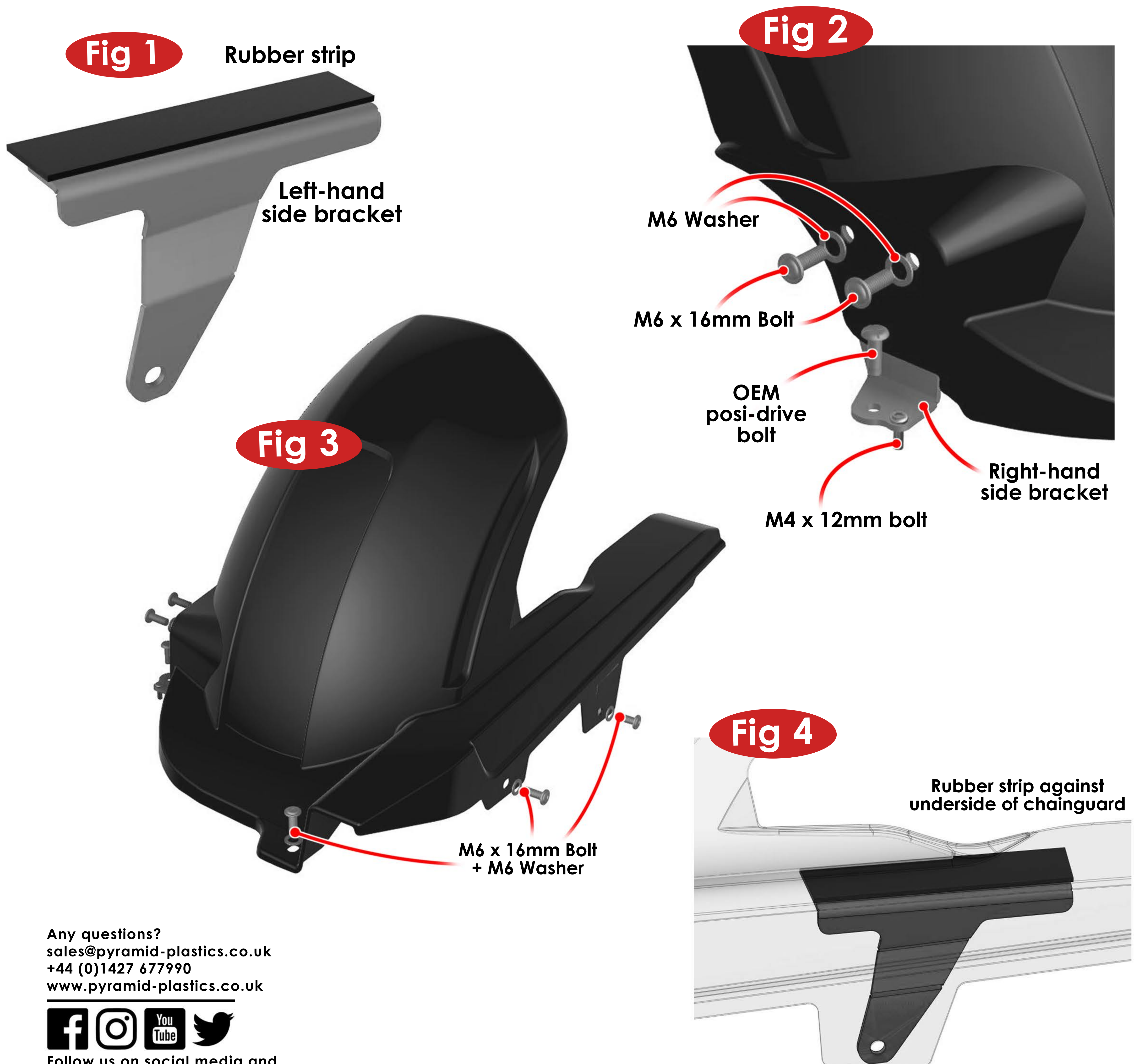

Any questions?
sales@pyramid-plastics.co.uk
 +44 (0)1427 677990
www.pyramid-plastics.co.uk



Follow us on social media and feel free to leave us a review!