

Description:	FlyScreen™	Model:	Various Motorcycles, Fork Diameter 44-51mm
Part Number:	Chrome Mounts: N2554-001, N2555-001 Black Mounts: N2554-002, N2555-002	Installation Time:	30 min.

Thank you for purchasing a National Cycle product. Read these instructions carefully and thoroughly before beginning work. Dealers, if installing this windshield for a customer, please give them this manual. It contains information needed to properly maintain and use this product.



Attention:

Special notes and cautionary measures which can prevent damage to the accessory or vehicle.



Note:

Tips for facilitation of operation, control and adjustment, as well as maintenance work.

Parts List, See Page 2



CLEANING AND MAINTENANCE

To clean the screen, wash with a clean soft cloth, plenty of warm water and if necessary, a non-abrasive soap such as dishwashing liquid. Flannel or soft chamois make good cleaning cloths. **Paint, glue residue or grease removal:** Moisten cotton with naphtha or turpentine followed by a wash as above.

National Cycle **Shield Wash™** (N1401-01) makes a good daily cleaner and comes with a handy travel size bottle. Shield Wash is safe for all windshields and helmet visors.

Do not clean polycarbonate in hot sun or high temperatures. Do not clean the screen with glass cleaners.

Do not allow brake fluid, alcohol, or strong solvents to contact the screen.

RAIN REPELLENT

Do not use rain protective products made for glass. We recommend National Cycle's **RainZip®** (N1410-01) to help shed water in rainy weather.

! WARNING

Never ride your motorcycle with loose accessory mounting hardware. Check the hardware for tightness regularly.

Today's motorcycles are built with enough frame rigidity to withstand the moderate loads imposed on them by the foreseeable addition of an accessory(ies). If an accessory(ies) adversely affects your motorcycle's stability, immediately remove the accessory(ies). Do not ride a motorcycle that exhibits unsafe handling traits.

Have experienced service personnel correct any problem before riding with the accessory(ies) installed. For further questions concerning handling problems associated with an accessory(ies), contact your dealer, motorcycle manufacturer, or accessory manufacturer.

Sunlight reflected off the inside curvature of the windscreen can, at certain times of day, cause extreme heat buildup on the motorcycles instruments and possibly even melt them. Exercise care in parking to avoid this. Park your motorcycle facing the sun or place an opaque object over this area.

Parts List For Kit-FJ included with N2554-001 and N2555-001

Item	Part No.	Description	Qty.	Notes and Tools
BAG#1267				
1	37-371831-000	Outer Clamp, Chrome	2	
2	37-371830-000	Inner Clamp, Black	2	
3	75-764012-000	.047" Rubber Spacer	2	Scissor
4	75-764011-000	.062" Rubber Spacer	2	"
5	75-764014-000	.094" Rubber Spacer	2	'
BAG#024				
6	37-371130-000	Bracket, Offset, Chrome, Aluminum	2	
7	51-515720-000	Screw, 8mm Allen	4	6mm Hex Wrench
8	49-492550-000	Washer, Serrated, External	4	

Parts List For Kit-FJ-001 included with N2554-002 and N2555-002

Bag#1268				
1	37-371832-000	Outer Clamp, Black	2	
2	37-371830-000	Inner Clamp, Black	2	Nut Welded to Bracket
3	75-764012-000	.047" Rubber Spacer	2	
4	75-764011-000	.062" Rubber Spacer	2	
5	75-764014-000	.094" Rubber Spacer	2	
BAG#1233				
6	37-371131-000	Bracket, Offset, Black, Aluminum	2	
7	51-515720-000	Screw, 8mm Allen	4	6mm Hex Wrench
8	49-492550-000	Washer, Serrated, External	4	

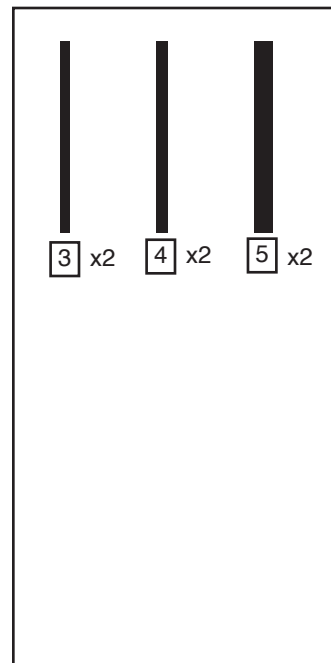
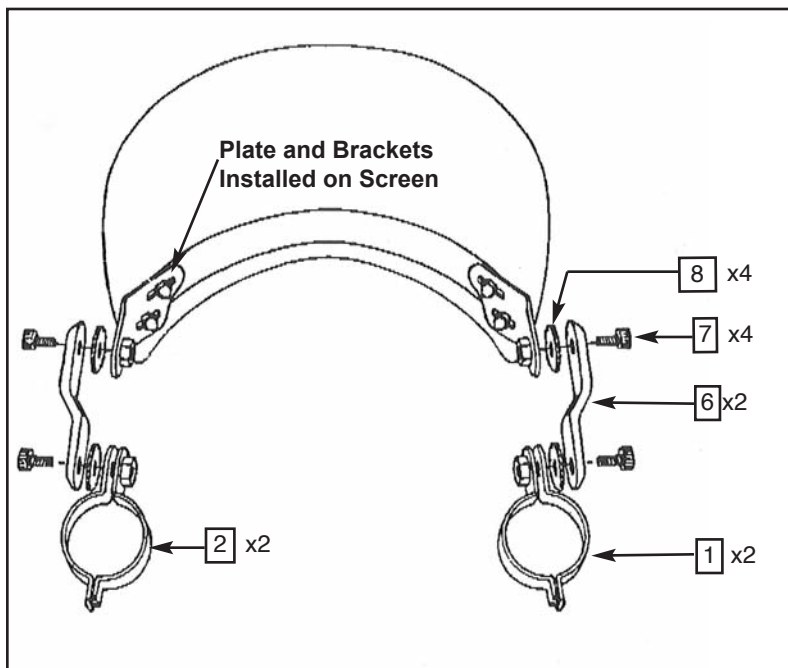

WINDSHIELD INSTALLATION

Preparing the Fork Clamps

1. Measure the motorcycle fork:

Diameter of Tube: _____

Width, Center to Center: _____

(Caliper or Soft Tape Measure) Figure 1

2. Select correct gaskets from the Bag. Refer to the Gasket Chart below and find your fork diameter. Select two Strips of each gasket required for your fork diameter.

 One Gasket Strip is required for each fork.

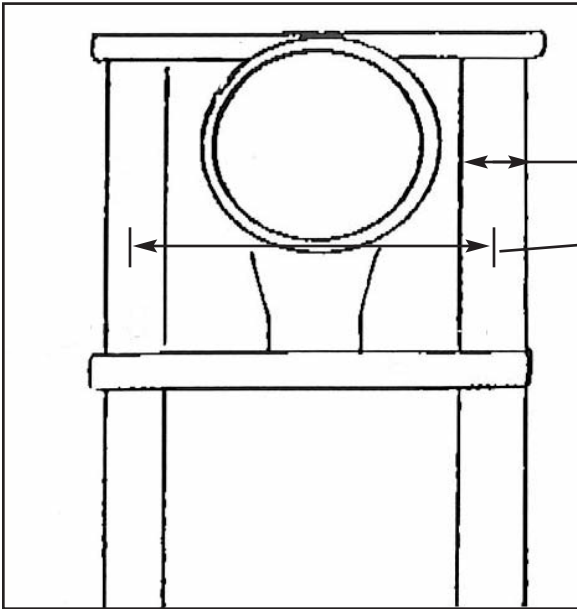

Figure 1

Gasket Chart

Fork Diameter	Qty.	Gasket Gauge Needed	
44mm	2	.062"	.094"
45mm	2	.047"	.094"
49mm	2	.062"	
51mm	2	.047"	

3. Cut each Gasket into 2 pieces. You will need 1 piece for each **half** of the Clamp. **(Sissors) Figure 2**

4. Before removing paper backing from Gasket, fit Gasket to Clamp to verify correct length. Cut Gasket material to exact length of Clamp half. **(Sissors) Figure 3**

5. Remove paper backing and apply the required Gaskets(s) to each Clamp half. **Do Not Apply Gasket Over Hinge. Figure 3**

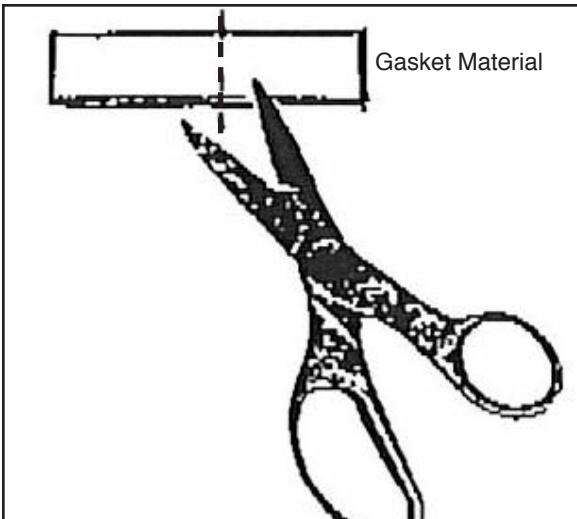

Figure 2

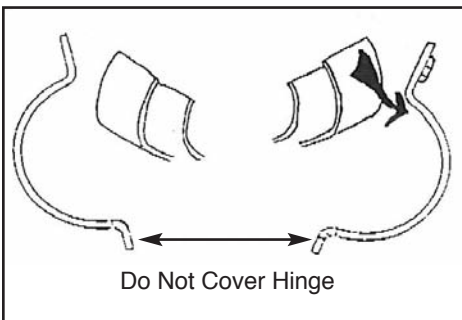

Figure 3

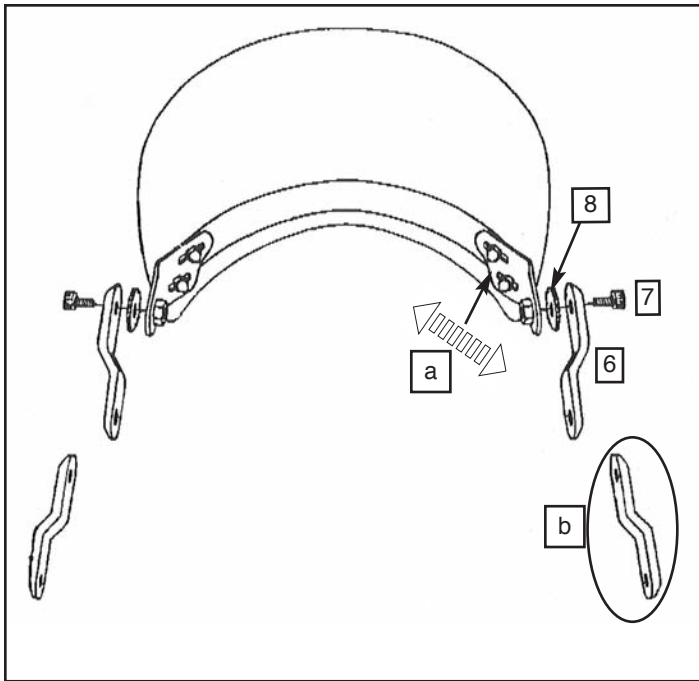



Figure 4

Assemble Offset Brackets to Windscreen

6. Use the fork width measurement to determine:

- a. Adjustment of Inside Plate Bracket
- b. Adjustment of Offset Bracket (6)

7. Change the position of the Offset Bracket (6) and the slotted Plate Bracket for Windshield to fit the motorcycle fork width. **Figure 4**

 Offset Bracket (6) can be reversed to provide more adjustment (b)

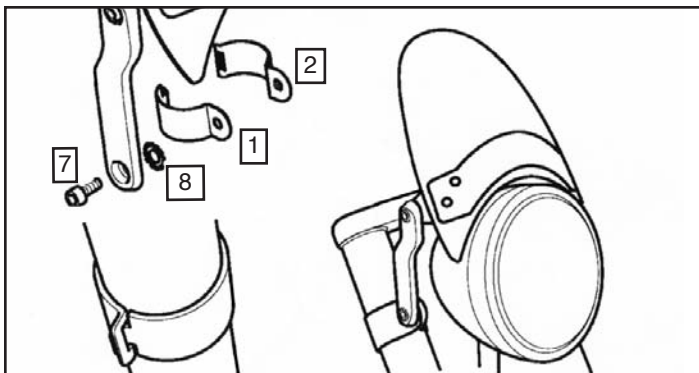

Figure 5

Install Windshield to Fork with Fork Clamps

8. Hold Windshield up to the motorcycle to check adjustment and determine Fork Clamp Position.

9. Hold Inner Clamp (2) to inside of fork tube, hook Outer Clamp (1) to the Inner Clamp.

10. Secure Clamp Assembly to the Offset Bracket with remaining M8 Screw (7) and Washer (8). (6mm Hex Wrench) **Figure 5**

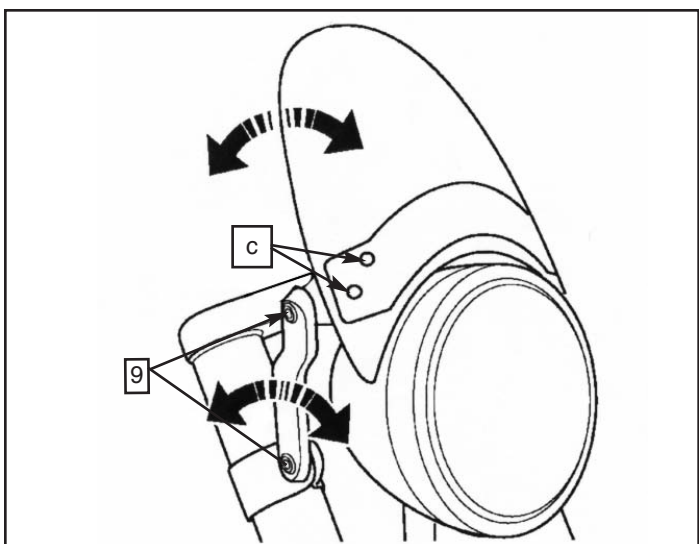

Figure 6

Final Adjustments and Tightening

11. Adjust the Windshield to the desired position and securely tighten the 4 Screws (7). (**6mm Hex Wrench**) **Figure 6**

12. Securely tighten the 4 Screws in the Windshield Plate Bracket (c) (**4mm Hex Wrench and 10mm Socket**) **Figure 6**