



**Quantum® Hardcoated Polycarbonate
Deflector Screen™ Windshield Models**
N25040, 7/8" (22mm) Bars
N25042, 1" (25mm) Bars and
N25044, 1.25" (31.5mm) Bars

Thank you for purchasing a National Cycle product. Read these instructions carefully and thoroughly before beginning work. Dealers, if installing this windshield for a customer, please give them this manual. It contains information needed to properly maintain and use this product.

Attention



Special notes and cautionary measures which can prevent damage to the accessory or motorcycle.

Note



Tips for facilitation of operation, control and adjustment, as well as maintenance.



CLEANING AND MAINTENANCE

To clean the screen, wash with a clean soft cloth, plenty of warm water and if necessary, a non-abrasive soap such as dishwashing liquid. Flannel or soft chamois make good cleaning cloths. Paint, glue residue or grease removal: Moisten cotton with naphtha or turpentine followed by a wash as above.

National Cycle Shield Wash™ (N1401-01) makes a good daily cleaner and comes with a handy travel size bottle. Shield Wash is safe for all windshields and helmet visors.

Do not clean polycarbonate in hot sun or high temperatures. Do not clean the screen with glass cleaners.

Do not allow brake fluid, alcohol, or strong solvents to contact the screen.

RAIN REPELLENT

Do not use rain protective products made for glass. We recommend National Cycle's RainZip® (N1410-01) to keep your windshield clear in rainy weather.



**Register your windshield online at www.nationalcycle.com
National Cycle 3-Year Limited Warranty**

National Cycle hereby warrants to the original registered owner of a National Cycle polycarbonate windshield for a period of three years from the date of purchase against breakage. This limited warranty is expressly limited to the replacement of the polycarbonate windshield. This limited warranty does not include scratches, coating failure, cosmetic wear and tear, replacement of hardware, or any consequential damages or expenses including labor cost of installation, removal and/or replacement, inconvenience, inbound freight expenses or damage to any other component of the motorcycle or any other accessories. Certain chemicals, generally known as acidic hydrocarbons, are known to cause polycarbonate damage and will not be covered under this limited warranty. Please refer to the cleaning instructions supplied with all National Cycle windshields.

Visit www.nationalcycle.com for further details, or call or write National Cycle

WARNING

Never ride your motorcycle with loose accessory mounting hardware. Check the hardware for tightness regularly.

Today's motorcycles are built with enough frame rigidity to withstand the moderate loads imposed on them by the foreseeable addition of an accessory(ies). If an accessory(ies) adversely affects your motorcycle's stability, immediately remove the accessory(ies). Do not ride a motorcycle that exhibits unsafe handling traits.

Have experienced service personnel correct any problem before riding with the accessory(ies) installed. For further questions concerning handling problems associated with an accessory(ies), contact your dealer, motorcycle manufacturer, or accessory manufacturer.

Sunlight reflected off the inside curvature of the windshield can, at certain times of day, cause extreme heat buildup on the motorcycles instruments and possibly even melt them. Exercise care in parking to avoid this. Park your motorcycle facing the sun or place an opaque object over this area.

Parts List				Notes and Tools
Item	Part Number	Description	Qty.	
1	25040	Deflector Screen Assembly	1	Screen with Mount Points Attached
	Kit-N25040,	Complete Mount Kit	1	Mount Kit For N25040 7/8" (22mm) Bars
	Kit-N25042,	Complete Mount Kit	1	Mount Kit For N25042 1" (25mm) Bars
	Kit-N25044,	Complete Mount Kit	1	Mount Kit For N25044 1.25" (31.5mm) Bars
	Bag #1157			
2	34-350235-000	Upright, 5/16" Rod	2	
3	42-429000-000	Locking Nut	2	3/4" Box Wrench or 19mm Box Wrench
4	44-449476-000	Bar Clamp, Left, 5/16"	1	
5	44-449477-000	Bar Clamp, Right, 5/16"	1	
6	51-515416-000	Screws, 1/4 20 x .75	2	
	Bag #052			
7	44-440300-000	Bracket, Telescope, Left	1	
8	44-440600-000	Bracket, Telescope, Right	1	
9	44-440400-000	Knob, QuickSet	2	
	Bag #051, #077, #078			
10	59-515200-000	Screws, 1/4 -20	4	Included in Bag#051, 077 and 078
11	44-446700-000	Tape, Double Stick	2	Included in Bag#051, 077 and 078
12	59-515100-000	Hex Key	1	Included in Bag#051, 077 and 078
	Bag #051			Bag#051 included in Kit- N25040 for 7/8" (22mm) Bars
13	44-440100-000	Pivot Strap, 7/8" (22mm)	2	For 7/8" (22mm) Diameter Handlebars
14	44-440200-000	Pivot Mount, 7/8" (22mm)	2	For 7/8" (22mm) Diameter Handlebars
	Bag #077			Bag#077 included in Kit- N25042 for 1" (25mm) Bars
13	44-440110-000	Pivot Strap, 1" (25mm)	2	For 1" (25mm) Diameter Handlebars
14	44-440210-000	Pivot Mount, 1" (25mm)	2	For 1" (25mm) Diameter Handlebars
	Bag #078			Bag#078 included in Kit- N25044 for 1.25" (31.5mm) Bars
13	44-440120-000	Pivot Strap, 1.25" (31.5mm)	2	For 1.25" (31.5mm) Diameter Handlebars
14	44-440220-000	Pivot Mount, 1.25" (31.5mm)	2	For 1.25" (31.5mm) Diameter Handlebars

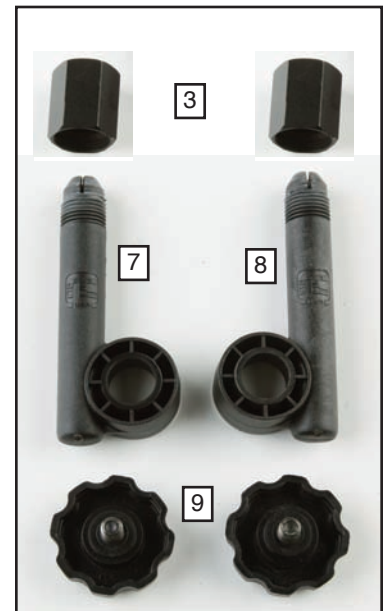
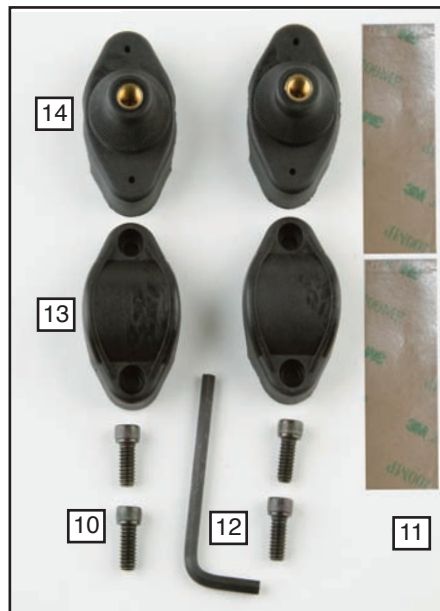
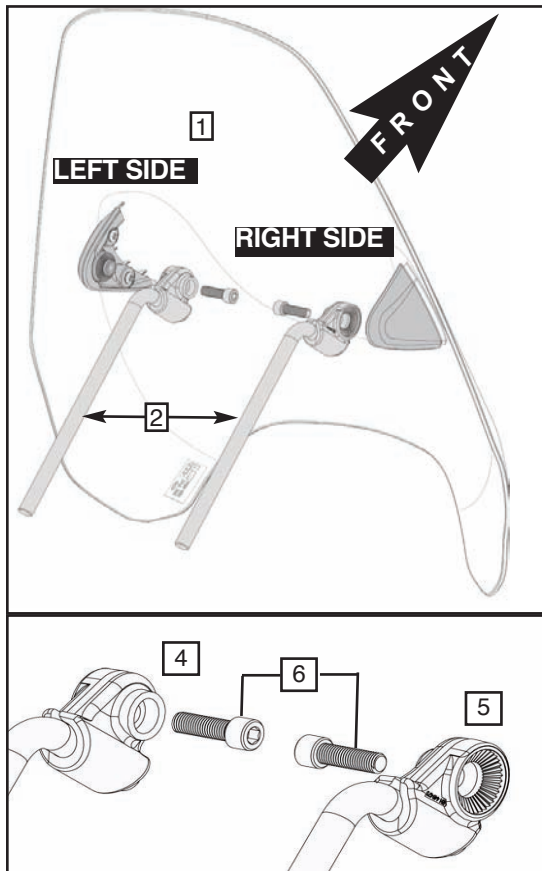



Figure 1

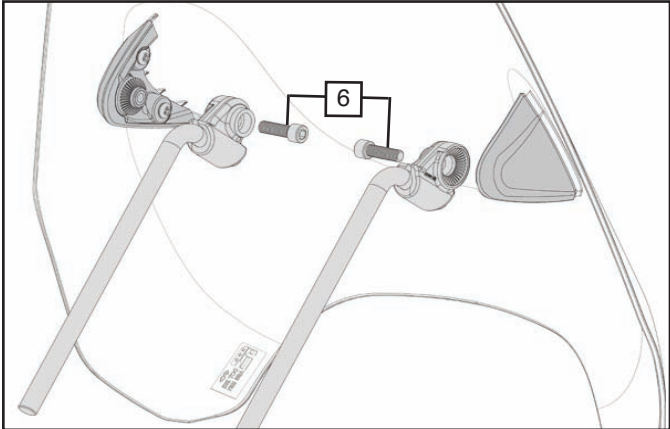

Figure 2



Figure 3



Figure 4

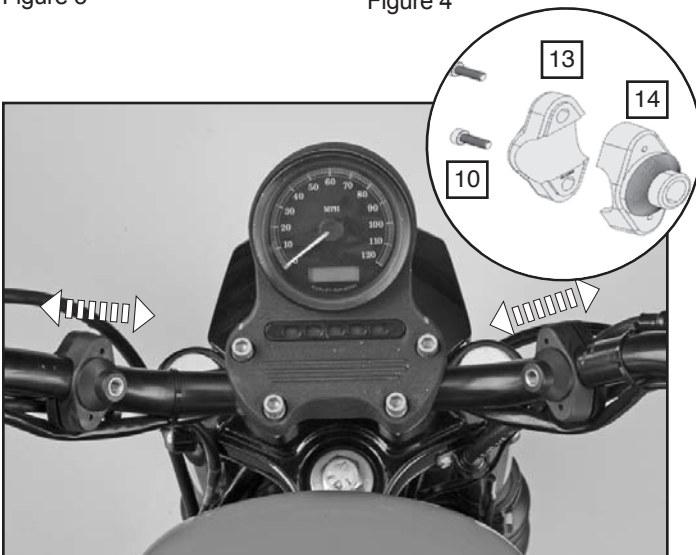

Figure 5

PREPARATION

1. Position motorcycle securely on its side stand.

INSTALLATION

INSTALL ROD CLAMPS TO RODS

1. Install the Left and Right Rod Clamps (4 and 5) to Rods. **Figure 1**

2. Using the Screws (6) install the Left and Right Rod Assemblies to the Windshield. Leave Screws loose until final adjustment. (**3/16" Hex Key**) **Figure 2**

INSTALL LOCKING NUTS

3. Loosely screw one Locking Nut (3) onto each Telescope Bracket. **Figure 3.**

4. Slide the Left Telescope Bracket Assembly on the Left Rod. Repeat on Right Side. Finger tighten as shown in **Figure 4.**

DETERMINE BEST LOCATION TO MOUNT PIVOT MOUNTS

5. Hold shield to motorcycle and select the best location around a vertical section of the handlebar to mount the Pivot Mounts (14).

Do not install the Double Stick Tape (11) in the next step. It will be done later.

6. Place Pivot Mount (14) on handlebar. Compress Pivot Mount along with Pivot Strap (13) and start the two 1/4-20 Hex Screws (10). **Do Not Tighten. (Hex Key Wrench) (10). Figure 5**

7. Adjust the Pivot Mounts up or down on the handlebars. Repeat on opposite side. Be sure both sides are symmetrical. **Figure 5**

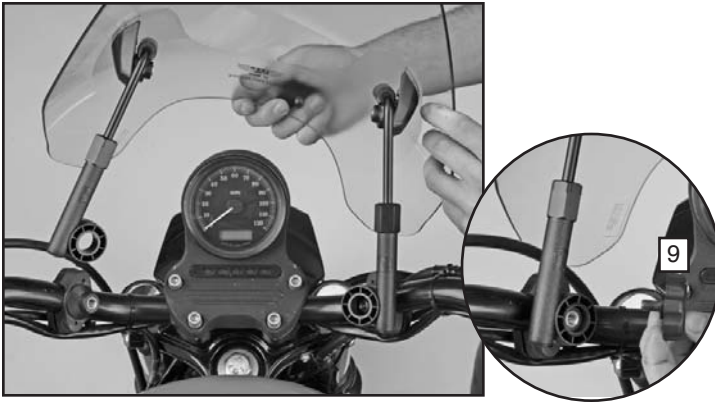

Figure 6



Figure 7



Figure 8



Figure 9

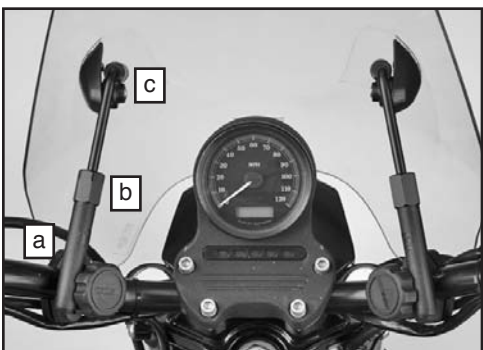

Figure 10

8. Set the Screen assembly over the headlight and attach the Telescope Brackets (7 and 8) to the QuickSet Pivot Mounts with QuickSet Knobs (9). **Figure 6**

A. Set the screen close to the headlight at the desired rake angle.

9. Sit On The Bike and adjust the Upright extension from the Telescope Brackets. **Figure 7**

B. For the most rigid installation, Minimize the Upright extension from the Telescope Brackets.

C. Slide the handlebar Pivot Mount assemblies further up the bar to reduce extension.

10. When satisfied with position of screen, hand tighten the Locking Nuts (3).

11. Now remove Quick Set Knobs to remove the screen.

12. Mark the placement and rotational position of the Pivot Mounts on the handlebars, then remove the Pivot Mounts and Straps. **(Tape) Figure 8**

13. Place one piece of Double Stick Tape (11) at the location on each handlebar where the Pivot Mounts were placed. Reinstall the Pivot Mounts. **Figure 9**

INSTALL WINDSHIELD

14. Install the Windshield Assembly to the Pivot Mounts with the QuickSet Knobs.

FINAL TIGHTENING

15. **Tighten Securely. Figure 10**

a. The Pivot Mounts and Pivot Straps. (3/16" Hex Key)

b. The Locking Nuts. (3/4" or Adjustable Wrench, Cloth for Protection)

c. The Two Screws In Rod Clamps. (3/16" Hex Key)

FURTHER ADJUSTMENTS

16. The rake of your Deflector Screen can now be changed at any time by simply loosening the two Screws (6), pivoting the screen on its mounts, and retightening the Screws. **(3/16" Hex Key)**

ENJOY YOUR NEW DEFLECTOR SCREEN WINDSHIELD