



Thank you for purchasing a National Cycle product. Read these instructions carefully and thoroughly before beginning work. Dealers, if installing this windscreen for a customer, please give them this manual. It contains information needed to properly maintain and use this product.



**Attention:**

Special notes and cautionary measures which can prevent damage to the accessory or motorcycle.



**Note:**

Tips for facilitation of operation, control and adjustment, as well as maintenance work.

**CONTENTS OF KIT**

Item	Description	Part No.	Qty.	Notes and Tools
1	VStream® Windscreen		1	All Stock Hardware Will Be Re-used



**TOOLS**

- Small Flat Blade Screwdriver
- 5mm Hex Key
- Tape (Optional)

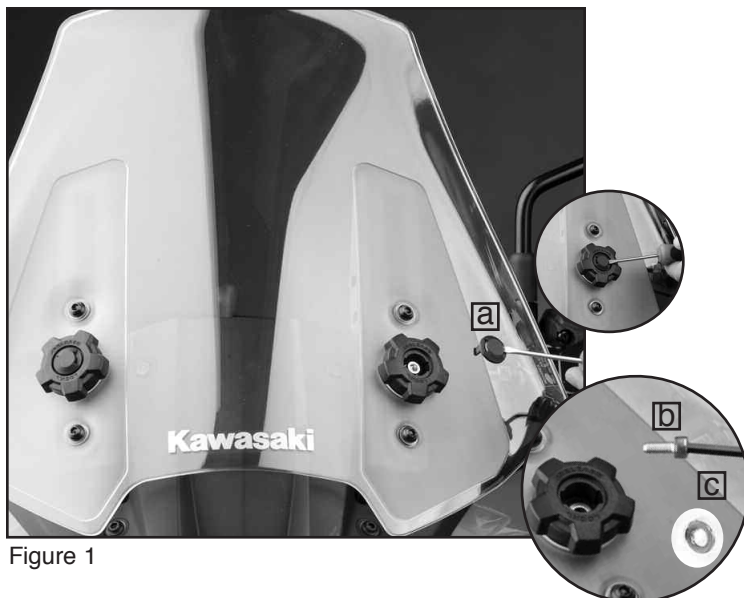

Figure 1

**PREPARATION**

1. Place motorcycle securely on its side stand.
2. Remove the 2, Caps (a) Screws (b) and Washers (c) holding the Adjustment Knobs in place. (Flat Blade Screwdriver, 5mm Hex Key) Figure 1



All stock hardware will be reused.

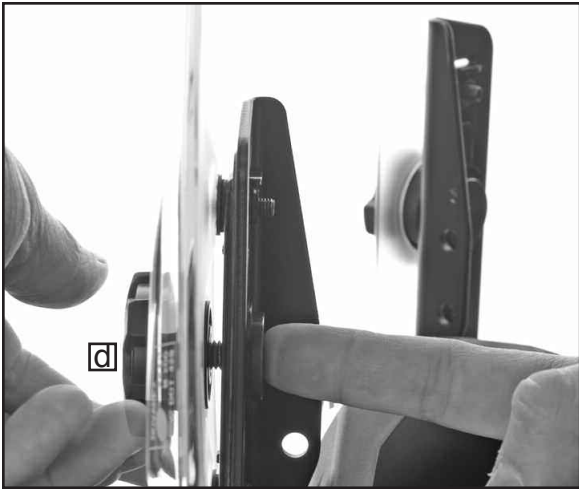

Figure 2

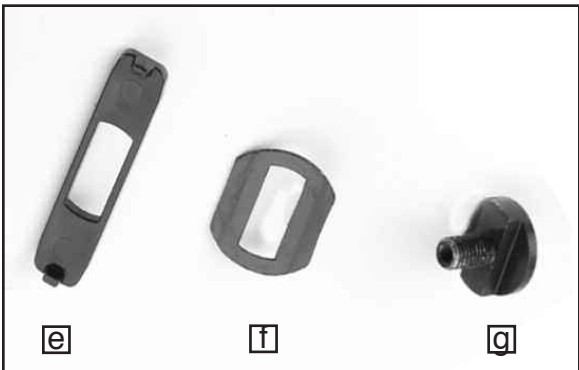

Figure 3



Figure 4

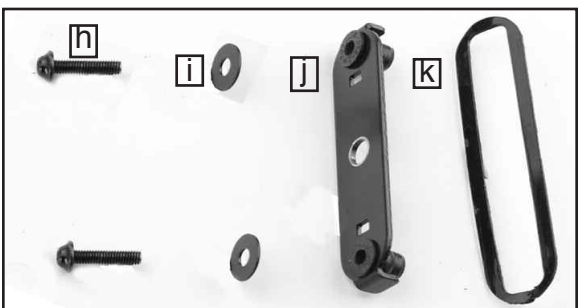

Figure 5

## PREPARATION

3. Remove the stock Adjustment Knob (d) from front of stock Windscreen. Removal of Knob will release parts (e, f, and g). Repeat on opposite side. **Figures 2 and 3**

 **All stock hardware will be reused.**

 **Note, the Upper Hex Screw is a longer length than the lower.**

4. Remove the 4, front Hex Screws from Stock Windscreen. Removal of Screws will release parts (h, i, j and k). **(5mm Hex Key) Figures 4 and 5**

 **All stock hardware will be reused.**

## INSTALLATION

1. Install Stock Parts (h, i, j and k) to the VStream Windshield. *Install longer Hex Screws at upper locations. (5mm Hex Key) Figure 6*

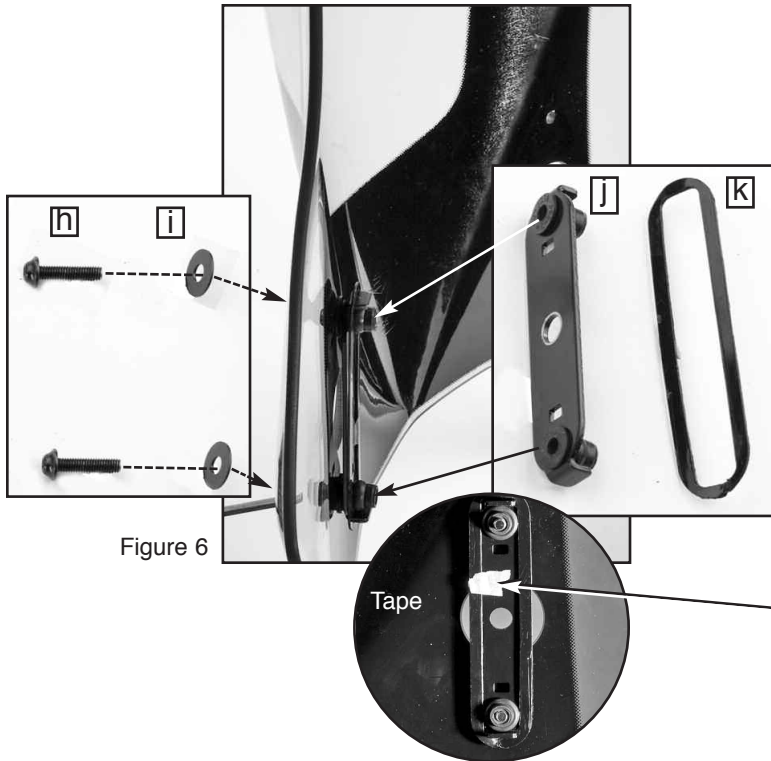

Figure 6

It will be helpful to hold stock part (k) in place with a small piece of Tape while completing installation. (Masking Tape) Figure 6 inset

Installation of VStream Windscreen should be done with the windshield adjustment in the *lowest* position.

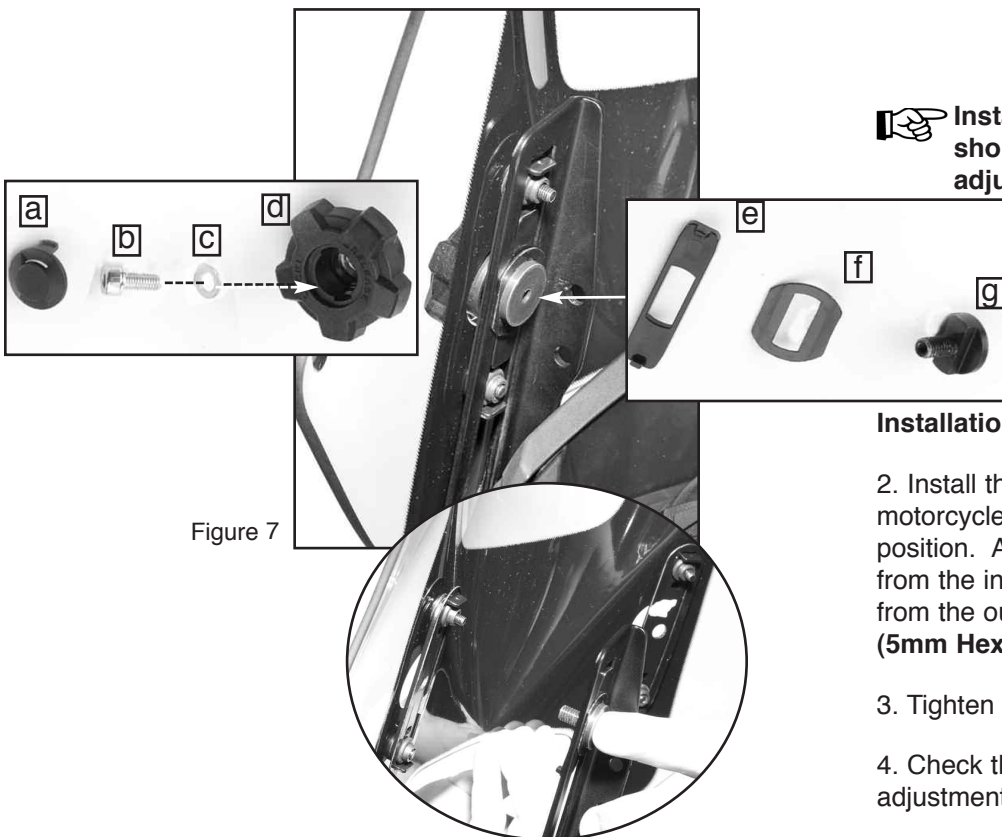

Figure 7

### Installation of VStream Windscreen

2. Install the VStream Windscreen to the motorcycle's windshield bracket in the lowest position. Assemble stock parts (e, f, and g) from the inside of Windshield and (b, c, and d) from the outside. Repeat on opposite side. (5mm Hex Key) Figure 7

3. Tighten Screws firmly. (5mm Hex Key)

4. Check the operation of the windscreen adjustment.

5. Install Caps (a).



Figure 8

## Finished Installation, Figure 8

### Enjoy your new VStream® Windshield



**CLEANING AND MAINTENANCE** To clean the screen, wash with a clean soft cloth, plenty of warm water and if necessary, a non-abrasive soap such as dishwashing liquid. Flannel or soft chamois make good cleaning cloths. **Paint, glue residue or grease removal:** Moisten cotton with naphtha or turpentine followed by a wash as above. National Cycle **Shield Wash™** (N1401-01) makes a good daily cleaner and comes with a handy travel size bottle. Shield Wash is safe for all windshields and helmet visors.

Do not clean polycarbonate in hot sun or high temperatures. Do not clean the screen with glass cleaners.

Do not allow brake fluid, alcohol, or strong solvents to contact the screen.

**RAIN REPELLENT** Do not use rain protective products made for glass. We recommend National Cycle's **RainZip®** (N1410-01) to keep your windscreen clear in rainy weather.



**Register your windshield online at [www.nationalcycle.com](http://www.nationalcycle.com)**

#### **National Cycle 3-Year Limited Warranty**

National Cycle hereby warrants to the original registered owner of a National Cycle polycarbonate windshield for a period of three years from the date of purchase against breakage. This limited warranty is expressly limited to the replacement of the polycarbonate windscreen. This limited warranty does not include scratches, coating failure, cosmetic wear and tear, replacement of hardware, or any consequential damages or expenses including labor cost of installation, removal and/or replacement, inconvenience, inbound freight expenses or damage to any other component of the motorcycle or any other accessories. Certain chemicals, generally known as acidic hydrocarbons, are known to cause polycarbonate damage and will not be covered under this limited warranty. Please refer to the cleaning instructions supplied with all National Cycle windshields.

**Visit [www.nationalcycle.com](http://www.nationalcycle.com) for further details, or call or write National Cycle**

## **! WARNING**

Never ride your motorcycle with loose accessory mounting hardware. Check the hardware for tightness regularly.

Today's motorcycles are built with enough frame rigidity to withstand the moderate loads imposed on them by the foreseeable addition of an accessory(ies). If an accessory(ies) adversely affects your motorcycle's stability, immediately remove the accessory(ies). Do not ride a motorcycle that exhibits unsafe handling traits.

Have experienced service personnel correct any problem before riding with the accessory(ies) installed. For further questions concerning handling problems associated with an accessory(ies), contact your dealer, motorcycle manufacturer, or accessory manufacturer.

**Sunlight reflected off the inside curvature of the windscreen can, at certain times of day, cause extreme heat buildup on the motorcycles instruments and possibly even melt them. Exercise care in parking to avoid this. Park your motorcycle facing the sun or place an opaque object over this area.**

*VStream® windshield patent no. 7,387,328*

National Cycle, Inc. PO Box 158 Maywood, IL 60153-0158 USA

708-343-0400 / Fax: 708-343-0625 / [www.nationalcycle.com](http://www.nationalcycle.com) / e-mail: [info@nationalcycle.com](mailto:info@nationalcycle.com)