

### Preparation

If the handlebar grips are not open at the end they will need to be cut open for the handguard to be fitted. Use a sharp knife to cut a hole in the end of each handgrip. On the right side the hole size should be neat and no smaller than the inside diameter of the throttle tube. Loosen the throttle assembly to move it outward about 20mm. Roll back the end of the grip and use a hacksaw to carefully cut off the end cap of the plastic throttle tube. Do not remove more than 3mm and take care not to cut the underlying handlebar. Before refitting, remove any burrs that could restrict throttle movement.

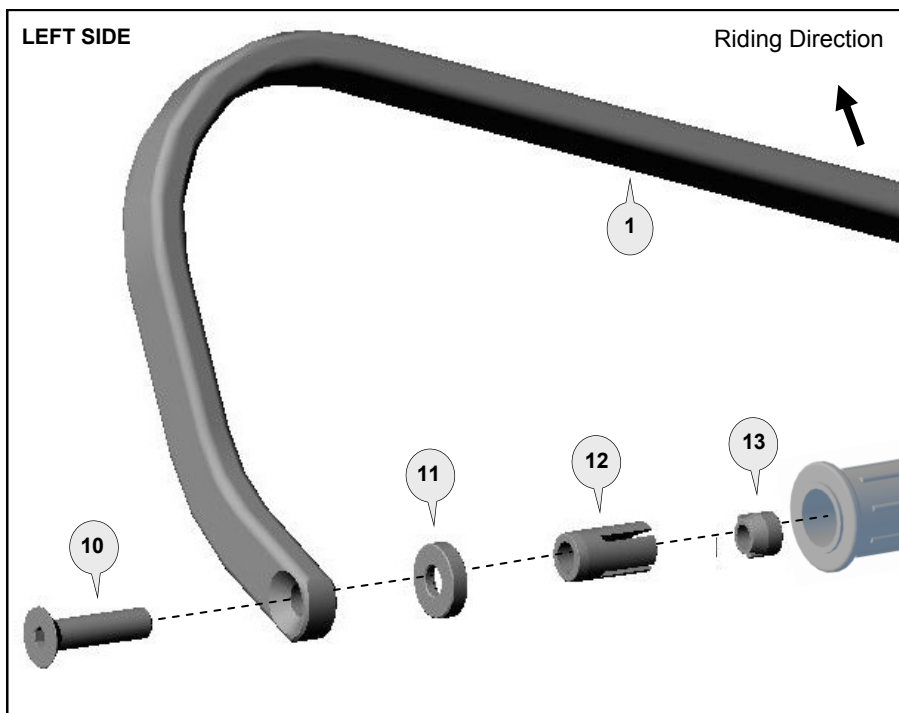

### Installation for Left Side.

Repeat for right side with applicable parts.

Loosely assemble the clamp to the handlebar as per diagram. Attach the handguard backbone with applicable parts to the handlebar end and also to the clamp connector (4).

Position backbone so it is horizontal when viewed from the side and tighten all bolts in the following order: (10), (8), (7) then (6).

**Note:** Most handlebars will require left connector (4) on left side. **Magura** and some other handlebars will require right connector (5) on left side.

**Important:** Use the specified torque setting over page.

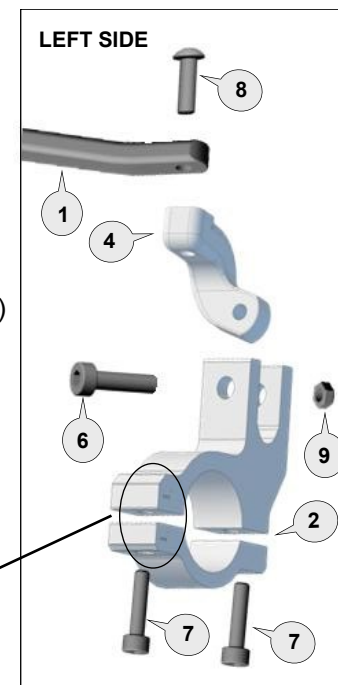
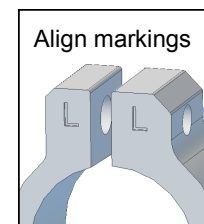

### Bar Side View

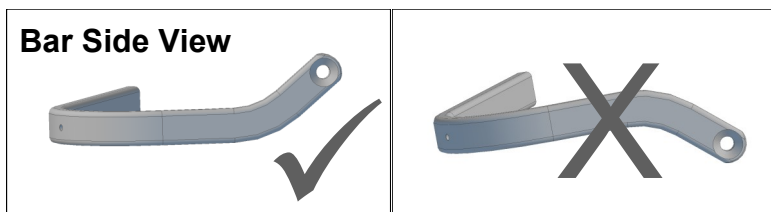













### Personalise Your Protection

Guard options sold separately

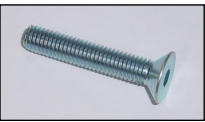
<b>JET</b>	JET-003
<b>VPS</b>	VPS-003
<b>Storm</b>	STM-003
<b>CARBON</b>	BCF-003



<b>1</b> Aluminium Bar  PN: BAR-V-030 Pcs. 1 Left & 1 Right	<b>2</b> Multi Fit Clamp LEFT  PN: MFC-L Pcs. 1 set	<b>3</b> Multi Fit Clamp RIGHT  PN: MFC-R Pcs. 1 set	<b>4</b> Connector LEFT  PN: CP8-L Pcs. 1	<b>5</b> Connector RIGHT  PN: CP8-R Pcs. 1	<b>6</b> Socket Head Bolt 30mm  PN: M6x30SHCSZP Pcs. 2	<b>7</b> Socket Head Bolt 20mm  PN: M6x20SHCSZP Pcs. 4	<b>8</b> Button Head Bolt 25mm  PN: M8x25BHCSZP Pcs. 2
<b>9</b> Nylock Nut 6mm  PN: M6LN Pcs. 2	<b>10</b> Flat Head Bolt  PN: M8x45FHCSZP Pcs. 2	<b>11</b> Collar  PN: BBEC5m Pcs. 2	<b>12</b> Expander  PN: BBE14A Pcs. 2	<b>13</b> Taper Nut  PN: NUT12 Pcs. 2	<b>NOTE:</b> If fitting to a Kawasaki KLE 1000 Versys (2015 on) – see special fitting instructions on the Barkbusters Website.  <a href="http://www.barkbusters.net/images/INS-BHG-152-00-NP2015_Versys_1000.pdf">http://www.barkbusters.net/images/INS-BHG-152-00-NP2015_Versys_1000.pdf</a>		

### CAUTION:

Installation of the handguard is safety-relevant work and can be complicated. We recommend the installation be performed by a motorcycle service technician. Rideworx accepts no liability for damages caused by improper mounting. All screws, bolts and nuts, including all replacement hardware provided by Rideworx, should be tightened to the torque specified in the below table. After the first 50km of riding check all screws, bolts and nuts are tightened to the correct torque. We recommend a medium strength liquid thread lock product on all fasteners.

### WARNING:

It is important there is a working clearance (approx 3mm) between the throttle grip end and the handguard to ensure a free closing throttle. Check operation of all handlebar controls, specifically the throttle, front brake, kill switch and clutch to ensure they are operating correctly and are in accordance with the OEM specifications. Do not ride the motorcycle if any controls are not operating correctly. Check periodically that all bolts are tight.

Recommended Torque Settings	
M6	10 Nm (7.4 lbf ft)
M8	20 Nm (14.8 lbf ft)



Phone: +61 (0)2 4271 8244  
 Email: [info@barkbusters.net](mailto:info@barkbusters.net)  
 Web: [www.barkbusters.net](http://www.barkbusters.net)

**Barkbusters**

### Disclaimer:

A failure to follow these fitting instructions could cause serious injury, death or property damage. These handguards are intended solely for use with motorcycles/ATV/snowmobiles/scooters that have not been modified. They are not designed to prevent injury or death while riding or in an accident or crash. The user must ensure that all controls are free of the handguards every time that they ride. By installing and/or using this product you acknowledge that you accept these terms and have followed the fitting instructions.

# Barkbusters

## FITTING INSTRUCTIONS for Carbon Fibre Handguard

Option for fitting with **Single Point Handlebar Mount** (sold separately)

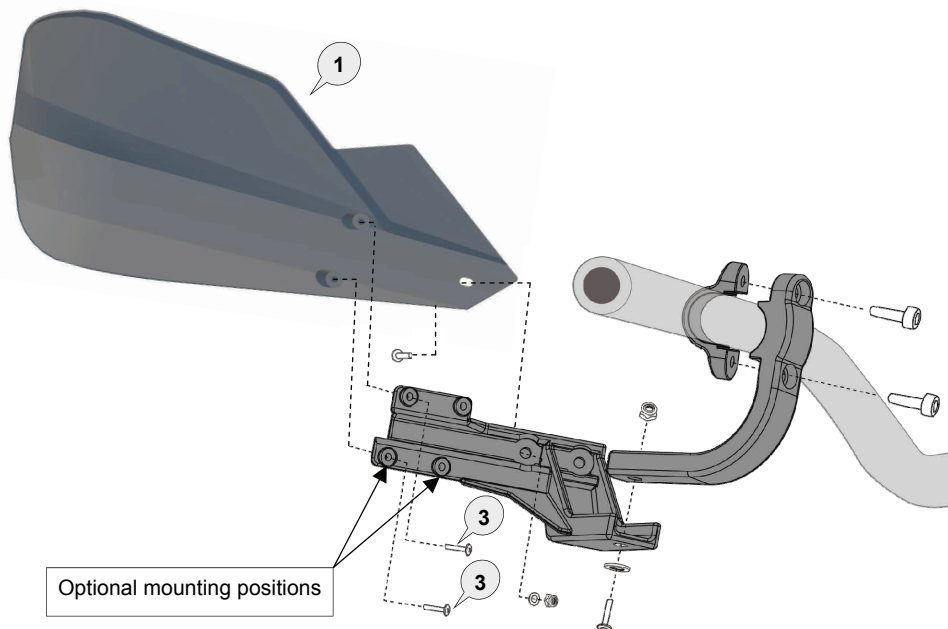

Option for fitting with Barkbusters **Aluminium Backbone** (sold separately)

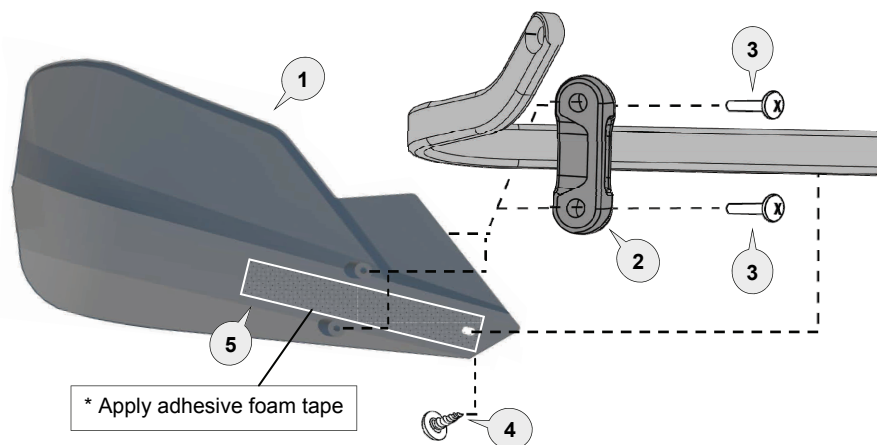

### 1 Carbon Fibre Guard



PN: BCF

Pcs. 2 (L/R)

### 2 Saddle



PN: Storm-Saddle

Pcs. 2

### 3 Pan Head Screw



PN: M4x10PHZP

Pcs. 4

### 4 Screw



PN: STSZ811MX11

Pcs. 2

### 5 Foam Tape



PN: FT1

Pcs. 2

### CAUTION:

Installation of the handguard is safety-relevant work and can be complicated. We recommend the installation be performed by a motorcycle service technician. Rideworx accepts no liability for damages caused by improper mounting. All screws, bolts and nuts, including all replacement hardware provided by Rideworx, should be tightened to the torque specified in the below table. After the first 50km of riding check all screws, bolts and nuts are tight. We recommend a medium strength liquid thread lock product on screw (3).

### WARNING:

Check operation of all handlebar controls, specifically the throttle, front brake, kill switch and clutch to ensure they are operating correctly and are in accordance with the OEM specifications. Do not ride the motorcycle if any controls are not operating correctly. Check periodically that all bolts are tight.

### Disclaimer:

A failure to follow these fitting instructions could cause serious injury, death or property damage. These handguards are intended solely for use with motorcycles/ATV/snowmobiles/scooters that have not been modified. They are not designed to prevent injury or death while riding or in an accident or crash. The user must ensure that all controls are free of the handguards every time that they ride. By installing and/or using this product you acknowledge that you accept these terms and have followed the fitting instructions.



Phone: +61 (0)2 4271 8244  
Email: [info@barkbusters.net](mailto:info@barkbusters.net)  
Web: [www.barkbusters.net](http://www.barkbusters.net)