



Lexan® FMR Hardcoated Polycarbonate  
 VStream Windshield for Late Model R1200GS  
 Z2485 Short, Dark Tint and Z2486 Short, Clear  
 Z2487 Mid, Clear and Z2488 Tall, Clear

Read these instructions carefully and thoroughly before beginning work. Dealers, if installing this windscreen for a customer, please give them this manual. It contains information needed to properly maintain and use this product.



**Attention:**

Special notes and cautionary measures which can prevent damage to the accessory or motorcycle.



**Note:**

Tips for facilitation of operation, control and adjustment, as well as maintenance work.

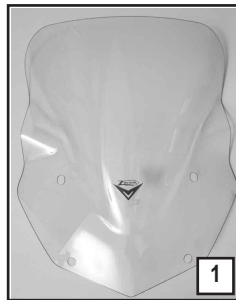

**CONTENTS OF KIT**

Item	Description	Part No.	Qty.
1	VStream® Windscreen		1

**TOOLS REQUIRED:**

T-25 Torx Wrench



There is variation in the stock R1200GS windscreen hardware from early production to later production. When installing the VStream windscreen, use **all the hardware** that came with your stock windscreen.

**STOCK HARDWARE, EARLY PRODUCTION**

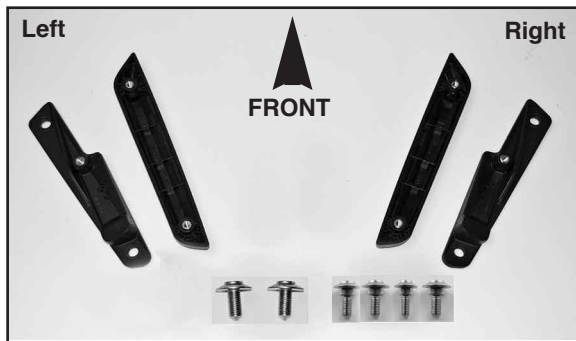

**STOCK HARDWARE, LATE PRODUCTION**

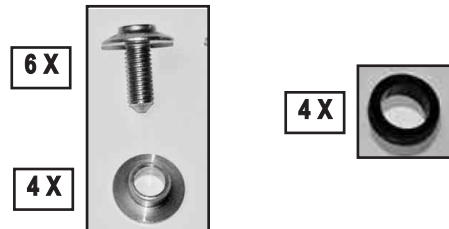
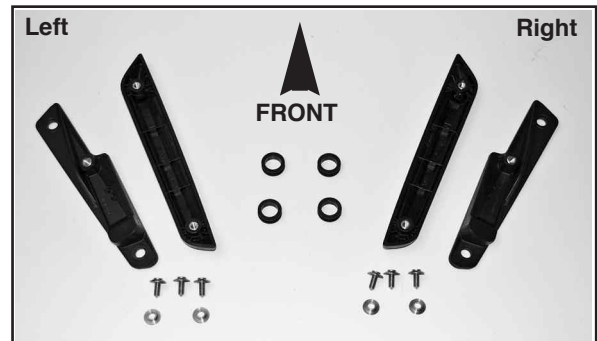

VStream® windscreen patent no. 7,387,328



Figure 1



Figure 2

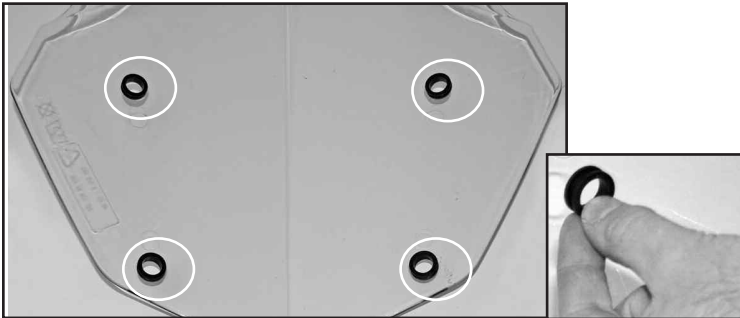

Figure 3



Figure 4



Figure 5

## PREPARATION



All stock hardware will be used in this installation.

1. Place motorcycle securely on its centerstand.
2. Remove the stock windscreen. Stock hardware will be **re-used**. (T25 Torx) **Figure 1**
3. Remove brackets from stock windscreen. (T25 Torx) **Figure 2**

4. (Late production only) Remove grommets from stock windscreen. **Figure 3**

## INSTALLATION

1. (Late production only) Install one grommet within each hole/slot of the VStream windscreen. **Figure 4**

2. Place outside trim onto the VStream Windscreen. **Figure 5**

3. (Late production only) Place one stock compression washer into each hole as shown in figure 5 inset. **Figure 5**

## INSTALLATION



Figure 6

4. Install brackets to the VStream Windscreen with the stock screws. Tighten Firmly. **(T25 Torx) Figure 6**

5. Repeat procedure on left side.



Figure 7

6. Install VStream Windscreen to motorcycle. **Figure 7.**



Figure 8

7. Secure windshield with stock screws. **Tighten Firmly.** Repeat procedure on left side. **(T25 Torx) Figure 8**

 An optional Stabilizer Kit, Z5220 is available for all R1200GS Windshields, Z2486-88 and recommended for the tallest Z2488. See page 4 for details.



An optional Stabilizer Kit, Z5220 is available for all R1200GS Windshields, Z2486-88 and recommended for the tallest Z2488. Please Contact your ZTechnik Dealer or [www.ZTechnik.com](http://www.ZTechnik.com).

Adding the Z5220 Stabilizer Kit does not interfere with the adjustment of the Windshield.



#### CLEANING AND MAINTENANCE

To clean the screen, wash with a clean soft cloth, plenty of warm water and if necessary, a non-abrasive soap such as dishwashing liquid. Flannel or soft chamois make good cleaning cloths. Paint, glue residue or grease removal: Moisten cotton with naphtha or turpentine followed by a wash as above. National Cycle Shield Wash™ (N1401-01) makes a good daily cleaner and comes with a handy travel size bottle. Shield Wash is safe for all windshields and helmet visors.

Do not clean polycarbonate in hot sun or high temperatures. Do not clean the screen with glass cleaners.

Do not allow brake fluid, alcohol, or strong solvents to contact the screen.

#### RAIN REPELLENT

Do not use rain protective products made for automotive glass. We recommend National Cycle's RainZip® (N1410-01) to keep your windscreen clear in rainy weather.

Ask for Shield Wash™ and RainZip® at your local dealer or visit [www.ztechnik.com](http://www.ztechnik.com).

### WARNING

Never ride your motorcycle with loose accessory mounting hardware. Check the hardware for tightness regularly.

Today's motorcycles are built with enough frame rigidity to withstand the moderate loads imposed on them by the foreseeable addition of an accessory(ies). If an accessory(ies) adversely affects your motorcycle's stability, immediately remove the accessory(ies). Do not ride a motorcycle that exhibits unsafe handling traits.

Have experienced service personnel correct any problem before riding with the accessory(ies) installed. For further questions concerning handling problems associated with an accessory(ies), contact your dealer, motorcycle manufacturer, or accessory manufacturer.

**Sunlight reflected off the inside curvature of the windscreen can, at certain times of day, cause extreme heat buildup on the motorcycle's instruments and possibly even melt them. Exercise care in parking to avoid this. Park your motorcycle facing the sun or place an opaque object over this area.**



Register your windshield online at [www.ZTechnik.com](http://www.ZTechnik.com)  
ZTechnik 3-Year Limited Warranty

ZTechnik hereby warrants to the original registered owner of a ZTechnik polycarbonate windshield for a period of three years from the date of purchase against breakage. This limited warranty is expressly limited to the replacement of the polycarbonate windscreen. This limited warranty does not include scratches, coating failure, cosmetic wear and tear, replacement of hardware, or any consequential damages or expenses including labor cost of installation, removal and/or replacement, inconvenience, inbound freight expenses or damage to any other component of the motorcycle or any other accessories. Certain chemicals, generally known as acidic hydrocarbons, are known to cause polycarbonate damage and will not be covered under this limited warranty. Please refer to the cleaning instructions supplied with all ZTechnik windshields.

Visit [www.ztechnik.com](http://www.ztechnik.com) for further details, or call or write ZTechnik / PO Box 158 / Maywood, IL 60153 / 708-3430400

ZTechnik PO Box 158 Maywood, IL 60153-0158 USA

708-343-0400 / Fax: 708-343-0625 / [www.ztechnik.com](http://www.ztechnik.com) / e-mail: [info@ztechnik.com](mailto:info@ztechnik.com)

©2013 National Cycle, Inc.

Page 4 of 4

10-119971-000 11/13 Rev A 08/14 Rev B 02/16