



Read these instructions carefully and thoroughly before beginning work. Dealers, if installing this windscreen for a customer, please give them this manual. It contains information needed to properly maintain and use this product.

	<p>Attention: Special notes and cautionary measures which can prevent damage to the accessory or motorcycle.</p>		<p>Note: Tips for facilitation of operation, control and adjustment, as well as maintenance work.</p>
---	---	---	--

CONTENTS OF KIT

Item	Description	Part No.	Qty.	Notes
1	VStream® Windscreen		1	
Bag #987				
2	Nylon Spacers	44-443520-000	2	Not required for 2013 and later models
3	Bushing, Top Hat	49-495671-000	2	
4	Screw	51-516420-000	2	
5	Washer, Flat	49-490317-000	2	
6	Bushing, Top Hat, Black	44-443540-000	6	

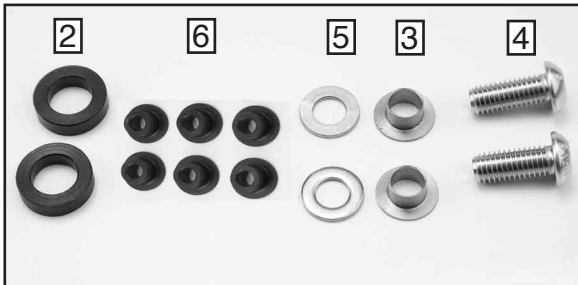

TOOLS REQUIRED:
T-25 Torx
T-40 Torx
5mm Hex Wrench



PREPARATION

1. Place motorcycle securely on its centerstand.
2. Remove the stock windscreen. (**T25 Torx; T40 Torx for Headlight Bolts**)

INSTALLATION

 **2012 AND EARLIER MODELS BEGIN ON PAGE 2.**
2013 AND LATER MODELS BEGIN ON PAGE 3.

VStream® windscreen patent no. 7,387,328



Figure 1

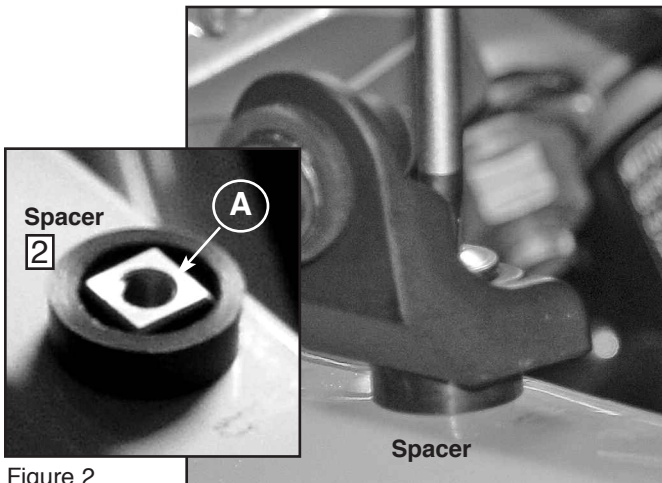

Figure 2

**FOR 2012 AND EARLIER MODELS
WHERE SQUARE NUT (A) IS STOCK PART**

1. Remove the windscreen swivel mount point to expose square nut. **(T25) Figure 1**
2. Place Spacer (2) from Bag #987 over nut. **Figure 2**
3. Reinstall Windscreen Swivel Mount. **(T25) Figure 2**

VStream® windscreen patent no. 7,387,328

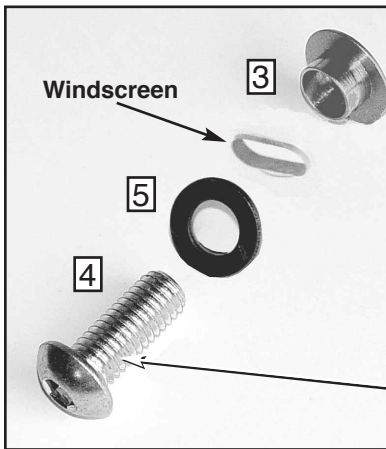

Figure 3

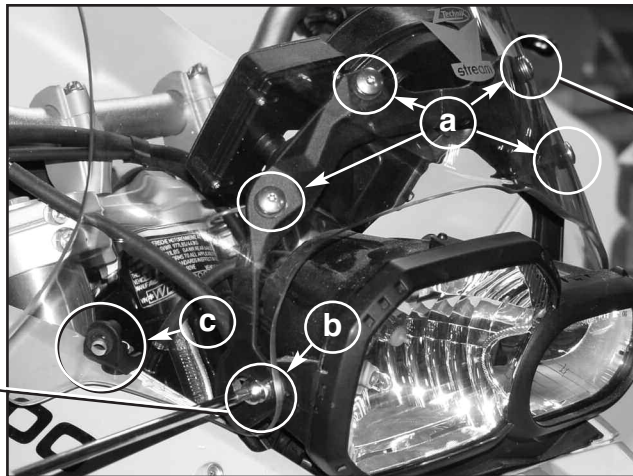

Figure 4

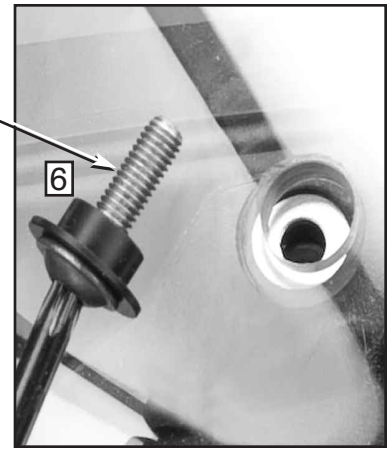

Figure 5



Figure 6; 2013 and Later

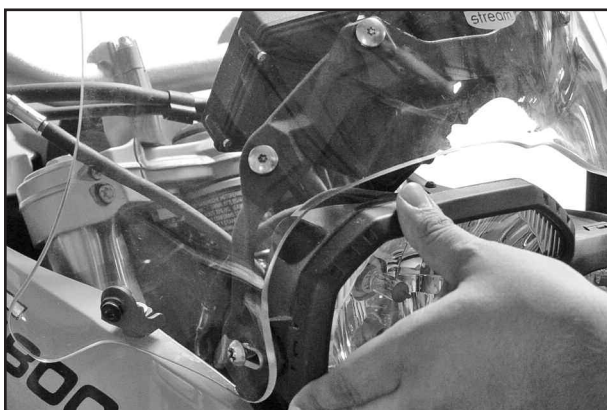

Figure 7

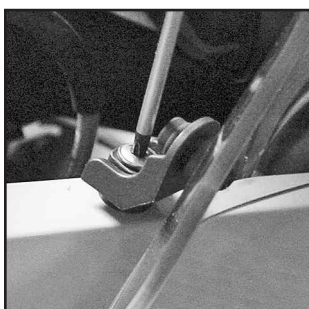



Figure 8; 2012 and Earlier

INSTALLATION OF VSTREAM WINDSCREEN FOR ALL MODELS

1. Place VStream windscreen on original mount points.
2. Place one Black Top Hat Bushing (6) onto a stock screw. **Figure 5**

 **2013 and later models:** When installing the VStream Windscreen at Point (a) **Do Not** use the stock black washers. Use supplied Black Top Hat (6) with stock screws.

3. Loosely install the four upper screw assemblies at point (a). **(T25) Figure 4**
4. At point (b) assemble hardware as shown. **(5mm Hex Key) Figures 3 and 6**
 - From inside of windscreen insert Top Hat Bushing (3) into hole with flat of Bushing against headlight housing.
 - Place Flat Washer (5) to outside of Windshield.
 - Loosely secure with Screw (4) supplied in Bag 987.

 **2013 and later models:** Retain large black OEM washer between headlight bracket and windscreen frame. **Figure 6**

5. Loosely install the Swivel Mount Screw at point (c). **(T25) Figure 4**
6. Adjust Windscreen. **Figure 7**
7. Tighten all hardware including the inside screw on the Swivel Mount Bracket. **(T25, 5mm Hex Key, T40) Figure 8**



CLEANING AND MAINTENANCE

To clean the screen, wash with a clean soft cloth, plenty of warm water and if necessary, a non-abrasive soap such as dishwashing liquid. Flannel or soft chamois make good cleaning cloths. **Paint, glue residue or grease removal:** Moisten cotton with naphtha or turpentine followed by a wash as above. National Cycle **Shield Wash™** (N1401) makes a good daily cleaner and comes with a handy travel size bottle. Shield Wash is safe for all windshields and helmet visors.

Do not clean polycarbonate in hot sun or high temperatures. Do not clean the screen with glass cleaners.

Do not allow brake fluid, alcohol, or strong solvents to contact the screen.

RAIN REPELLENT

Do not use rain protective products made for automotive glass. We recommend National Cycle's **RainZip®** (N1410) to keep your windshield clear in rainy weather.

Ask for Shield Wash™ and RainZip® at your local dealer or visit www.ztechnik.com.



Register your windshield online at www.ZTechnik.com

ZTechnik 3-Year Limited Warranty

ZTechnik hereby warrants to the original registered owner of a ZTechnik polycarbonate windshield for a period of three years from the date of purchase against breakage. This limited warranty is expressly limited to the replacement of the polycarbonate windshield. This limited warranty does not include scratches, coating failure, cosmetic wear and tear, replacement of hardware, or any consequential damages or expenses including labor cost of installation, removal and/or replacement, inconvenience, inbound freight expenses or damage to any other component of the motorcycle or any other accessories. Certain chemicals, generally known as acidic hydrocarbons, are known to cause polycarbonate damage and will not be covered under this limited warranty. Please refer to the cleaning instructions supplied with all ZTechnik windshields.

Visit www.ztechnik.com for further details, or call or write ZTechnik / PO Box 158 / Maywood, IL 60153 / 708-3430400

⚠ WARNING

Never ride your motorcycle with loose accessory mounting hardware. Check the hardware for tightness regularly.

Today's motorcycles are built with enough frame rigidity to withstand the moderate loads imposed on them by the foreseeable addition of an accessory(ies). If an accessory(ies) adversely affects your motorcycle's stability, immediately remove the accessory(ies). Do not ride a motorcycle that exhibits unsafe handling traits.

Have experienced service personnel correct any problem before riding with the accessory(ies) installed. For further questions concerning handling problems associated with an accessory(ies), contact your dealer, motorcycle manufacturer, or accessory manufacturer.

Sunlight reflected off the inside curvature of the windshield can, at certain times of day, cause extreme heat buildup on the motorcycle's instruments and possibly even melt them. Exercise care in parking to avoid this. Park your motorcycle facing the sun or place an opaque object over this area.

View other ZTechnik® products for the F800GS or F650GS Twin online at www.ztechnik.com or www.nationalcycle.com

VStream® windshield patent no. 7,387,328