

BIKERFACTORY

touring sport & off-road

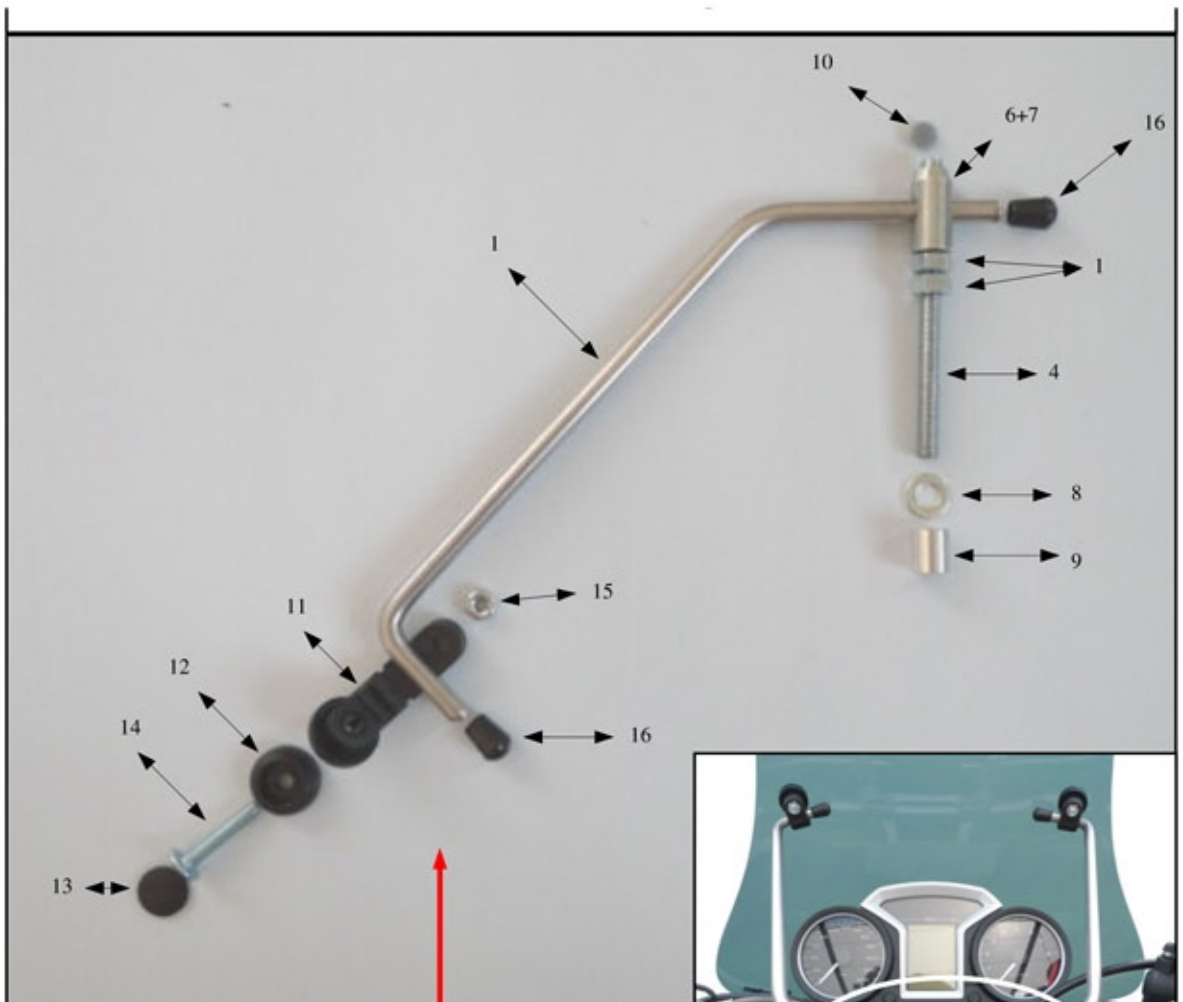

**Serraggio:
2.5 KG/Nm**

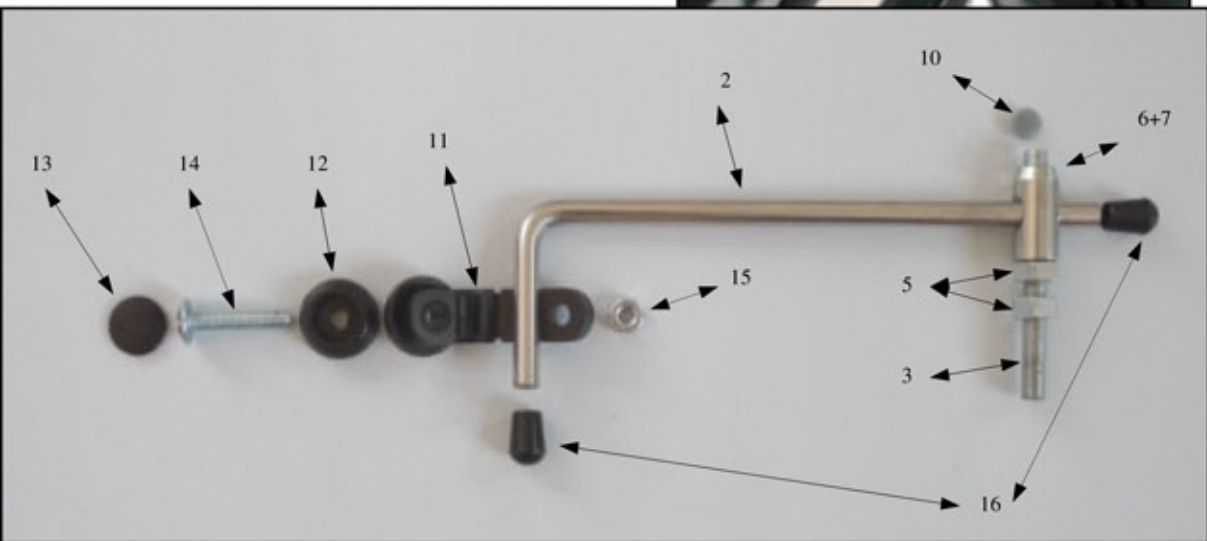
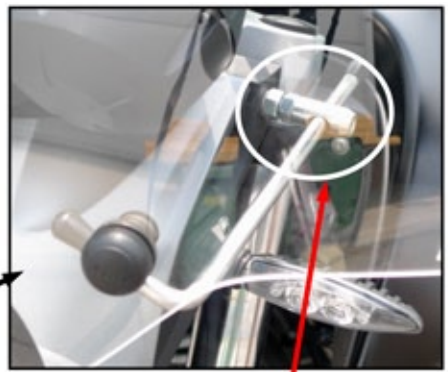

Nomenclatura:

- 1 - Staffe acciaio inox L. 31 mm.
- 2 - Staffe acciaio inox L. 23 mm.
- 3 - Prigionieri Ø 8 L. 50 mm.
- 4 - Prigionieri Ø 8 L. 80 mm.
- 5 - Dadi M8.
- 6 - Boccole filettate (n° 3).
- 7 - Grani 8x10.
- 8 - Rondelle M8.
- 9 - Boccole L. 15 mm.
- 10 - Tappini.
- 11 - Collari Ø 8.
- 12 - Boccola.
- 13 - Tappo copri vite
- 14 - Viti M6x30.
- 15 - Dadi M6.
- 16 - Tappini in gomma.