

Thank you for purchasing a National Cycle Accessory. Before beginning installation please look over this guide and be sure one possess the skills and workshop tools to properly complete the installation. Otherwise a motorcycle dealer would be glad to complete the installation.

**Dealers:** If installing the windshield for a customer please give them this manual. It contains information needed to properly maintain and use this product.



**Attention:**

Special notes and cautionary measures which can prevent damage to the accessory or motorcycle.



**Note:**

Tips for facilitation of operation, control and adjustment, as well as maintenance work.

**PARTS LIST**

	<u>INDEX</u>	<u>DESCRIPTION</u>	<u>QTY.</u>
	1	Windscreen	1
<b>KIT GH</b>	2	Left Mount Bracket	1
	3	Right Mount Bracket	1
	4	Clamp Half, Inner	2
<b>BAG #1044</b>	5	Rubber Clamp Dampener, Inner	2
	6	Rubber Clamp Dampener, Outer	2
	7	CS, HS M6 x 20 SS	4
	8	Cap, Black	4
	9	Grommet	4
	10	CS, Flat HS M6 x 12 SS	4

**TOOLS**

- 5mm Allen Wrench (Hex)
- 4mm Allen Wrench (Hex)
- 10mm Box Wrench

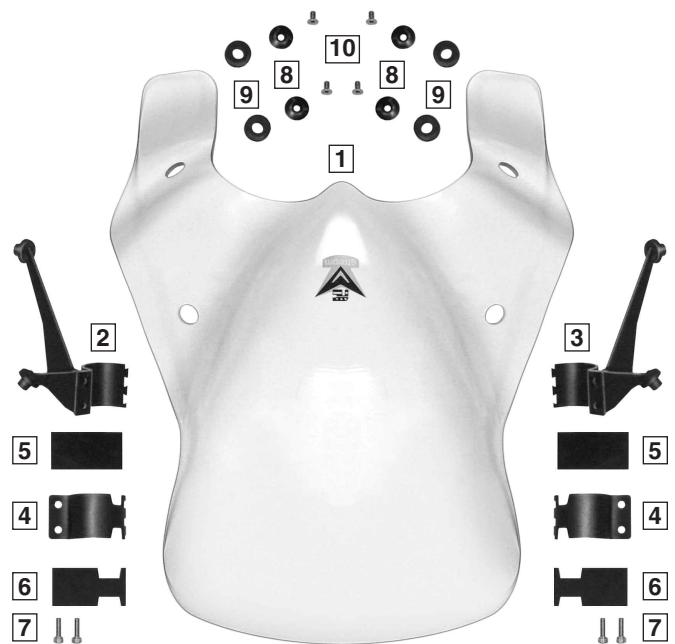

VStream® Windscreens are covered by patent #7,387,328. VStream® and National Cycle® are registered trademarks of National Cycle, Inc.

**PREPARATION**

1. Position the motorcycle securely on its stand.



Cover the front fender with a cloth to avoid scratches.

Install one rubber grommet around edge of each hole in windscreen. **Figure 1**

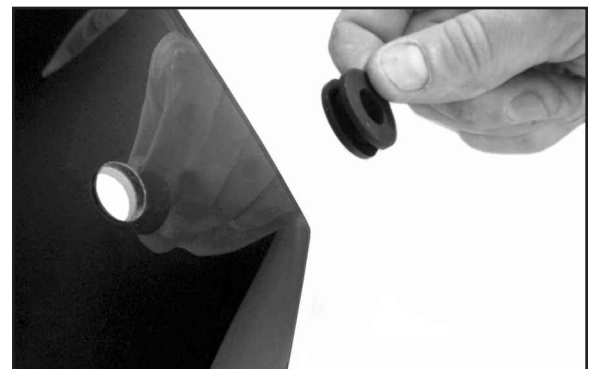

Figure 1

## HEADLIGHT/TURN SIGNAL ASSEMBLY REMOVAL

1. Remove the two M6 hex nuts located on the back side of the headlight assembly behind fork, under upper triple tree. **(10mm box wrench).** **Figure 2, 2a**



Figure 2a



Figure 2

2. Disengage the headlight's upper mounting pegs from the rubber mounted brackets located on the upper triple tree. **Figure 3**

3. Swing the lower half of the assembly forward, and carefully pull upward on the housing. **Figure 4**



Cover front fender with a rag or towel. Carefully dislodge any wiring and connectors, and place headlight assembly on front fender.



Figure 3



Figure 4

## INSTALLATION OF BRACKETS

1. Install Inner Rubber Clamp Dampeners (5) to Inner Clamp Halves (4). **Figure 5**

2. Install Outer Rubber Clamp Dampeners (6) to the Left and Right Mount Brackets (2, 3). **Figure 5**

3. Orient Left Bracket (2) and Right Bracket (3). **Figure 6**

**Continue installation beginning on the right side of the bike.**

4. Turn the handlebars so that the front wheel of the bike is steering left. This will give you additional access to the working area.

5. Clasp Left Mount Bracket around fork diameter. The teeth of the Clamp will face inward. The cut-out on the Inner Bracket Half should clear the wire form fasteners located along the inside of the fork. Slide Bracket upwards until it seats directly underneath the upper triple tree. **Figure 7**

6. Insert two M6 x 1.0 x 20mm Hex Socket Cap Screws (7). Lightly tighten fasteners so that bracket may still be rotated around fork tube. This will aid in the alignment of the Bracket(s) to the VStream Windscreens. **Figure 8**

7. Turn forks in the opposite direction and repeat Bracket installation procedure on the left side of motorcycle.

8. Both Mount Brackets should now be installed on the fork tubes as shown. Reinstall the headlight/turn signal assembly. **Figure 9**

**Torque the two M6 hex nuts removed from motorcycle (Page 2, Step 1) to the recommended torque in the motorcycle's manual. (10mm box wrench).**

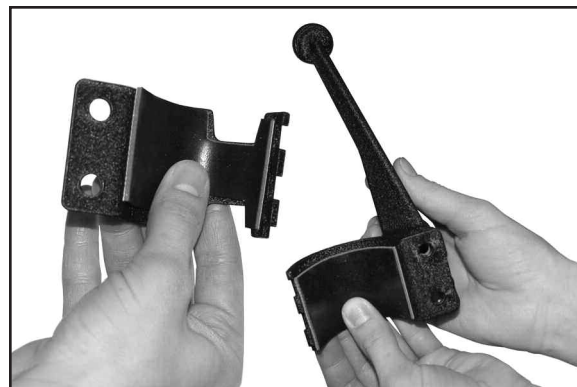

Figure 5

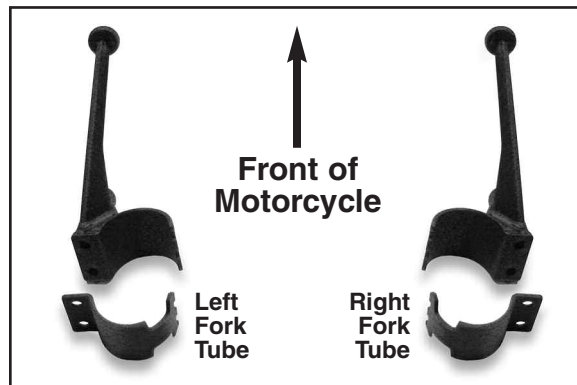

Figure 6



Figure 7



Figure 9



Figure 8

## INSTALLATION OF WINDSCREEN



All four mounting points are on different planes, so you'll have to flex the shield a bit to get everything to line up properly.

1. Place Windscreen (1) onto Mount Brackets. Adjust Mounts to align to holes in Windscreen. Check alignment of Windscreen to headlight. Check Windscreen for symmetry left and right.

### Figure 10

2. Using one M6 x 12 Screw (10) and one Black Cap (8), attach Windscreen to Mounts. Repeat for all four Windscreen holes. Tighten screws firmly. **(4mm Hex Wrench) Figure 10**

3. Check all clearances. Turn forks full left and right. Check clearances of Mount Brackets to motorcycle. Make any necessary adjustments.

4. Lastly, torque the four M6 x 20 Screws on Left/Right Mount Brackets to 6 ft.-lbs. (8 Nm). **Page 3, Figure 8**

**Enjoy your new VStream Windscreen!**



Figure 10

## MAINTENANCE

**Cleaning:** Wash with a clean soft cloth, plenty of warm water and, if necessary, a non-abrasive soap such as dishwashing liquid. Flannel or soft chamois make good cleaning cloths. Do not use rain protective products on the screen due to the solvent action of the alcohol in these products. Do not allow brake fluid, alcohol, or strong solvents to contact the screen.

National Cycle Windshield Wash Part number N1401 is recommended for everyday cleaning. Product is supplied with a handy travel size container and rag for easy storage on the motorcycle. Inquire with your local dealer or visit: [www.nationalcycle.com](http://www.nationalcycle.com)

## WARNING

Never ride your motorcycle with loose accessory mounting hardware. Check the hardware for tightness regularly.

Today's motorcycles are built with enough frame rigidity to withstand the moderate loads imposed on them by the foreseeable addition of an accessory(ies). If an accessory(ies) adversely affects your motorcycle's stability, immediately remove the accessory(ies). Do not ride a motorcycle that exhibits unsafe handling traits.

Have experienced service personnel correct any problem before riding with the accessory(ies) installed. For further questions concerning handling problems associated with an accessory(ies), contact your dealer, motorcycle manufacturer, or accessory manufacturer.



### National Cycle 3-Year Limited Warranty

Register your windshield online at: [www.nationalcycle.com/register.html](http://www.nationalcycle.com/register.html)  
or contact National Cycle Customer Service at 708-343-0400

National Cycle hereby warrants to the original registered owner of a National Cycle polycarbonate windshield for a period of three years from the date of purchase against breakage. This limited warranty is expressly limited to the replacement of the polycarbonate windshield. This limited warranty does not include scratches, coating failure, cosmetic wear and tear, replacement of hardware, or any consequential damages or expenses including labor cost of installation, removal and/or replacement, inconvenience, inbound freight expenses or damage to any other component of the motorcycle or any other accessories. Certain chemicals, generally known as acidic hydrocarbons, are known to cause polycarbonate damage and will not be covered under this limited warranty. Please refer to the cleaning instructions supplied with all National Cycle windshields.