



Thank you for purchasing a National Cycle® product. Please read these instructions carefully and thoroughly before beginning work. Dealers if installing this windshield for a customer please give them this manual. It contains information needed to properly maintain and use this product.

**Attention**



Special notes and cautionary measures which can prevent damage to the accessory or motorcycle.

**Note**



Tips for facilitation of operation, control and adjustment, as well as maintenance.

**PARTS LIST**

Item	Description	Qty.
<b>Z2437 and Z2438</b>		
1	Windsheild, Quantum Hardcoated Polycarbonate	1
2	37-370220-000 Bracket, Left	1
3	37-370221-000 Bracket, Right	1
<b>BAG #1025</b>		
4	51-514227-000 Screw, M6 x 25	4
5	34-346037-000 Cap, Black Anodized	4
6	49-495669-000 Bushing	4
7	44-447304-000 Grommet	4
8	42-483000-000 Nut	4
9	49-490205-000 Washer, Flat	2
10	55-586400-000 Carriage Bolt M10 x 25	2
11	75-763145-000 Gasket, Applies to Bracket	2
12	34-348001-000 Ball Stud	2
13	34-340170-000 Adjuster Knob	2
14	37-370222-000 Shim, Left	1
15	37-370223-000 Shim, Right	1

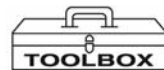

1/2" Box Wrench  
3 mm Allen Wrench

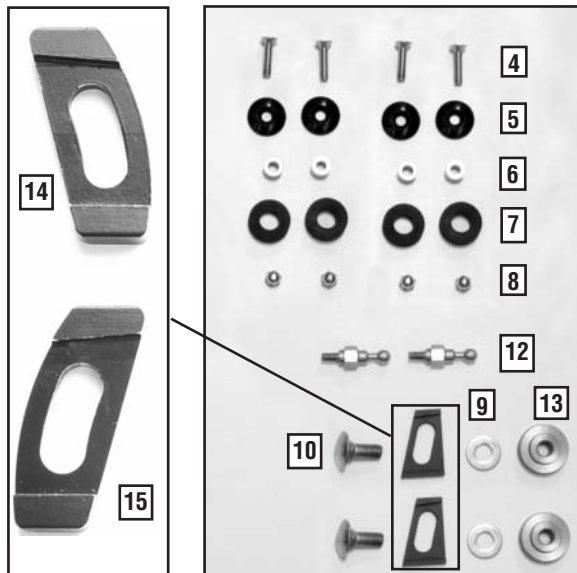

**PREPARATION and REMOVAL OF PARTS**

1. Position the motorcycle securely on center stand.
2. Remove the stock windsheild and hardware. Hardware will not be reused.
3. Install a Gasket (11) to the Left and Right Brackets. **Figure 1**

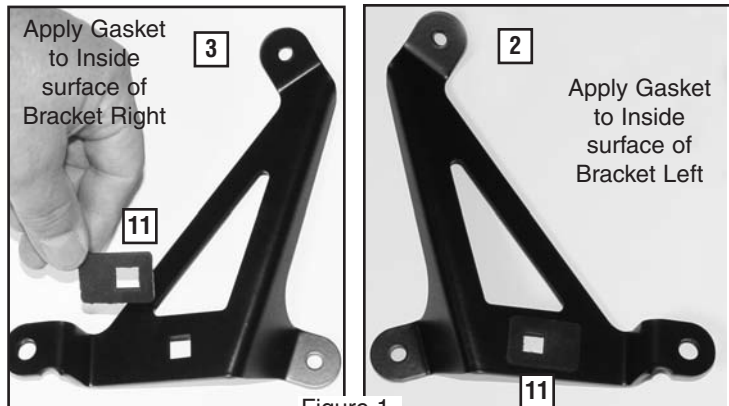

The Left and Right side of motorcycle is determined while sitting on the bike.

Figure 1

## INSTALLATION

### Install the bracket to the motorcycle.

1. Install the Right Windshield Bracket (2) to the motorcycle with one Ball Stud (12). Tighten until Ball Stud is firmly seated. Bracket will pivot at this point. Repeat on opposite side of motorcycle. **(1/2" Box Wrench) Figure 2**
2. Insert a Carriage Bolt (10) through the Bracket from the outside.
3. Install Right Shim (15), Washer (9) and Knob (13) as shown in **Figures 3-6**.
4. Repeat procedure on Left side of motorcycle.

## INSTALLATION

### Install the Windshield to the Brackets

1. Install one Grommet and one Bushing into each hole on the windshield. **Figure 7**



Figure 2

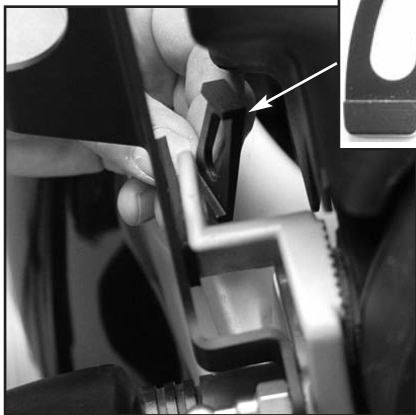
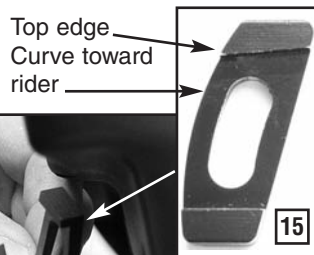

Figure 3

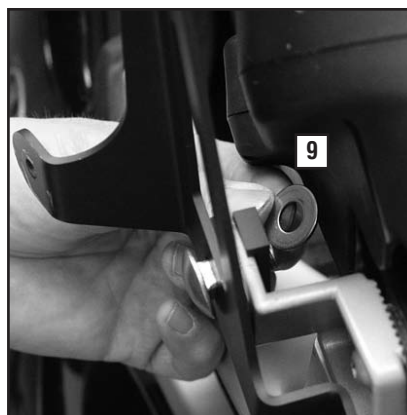

Figure 4

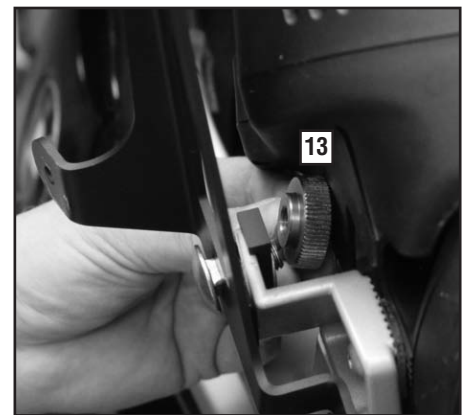

Figure 5



Figure 6, Completed

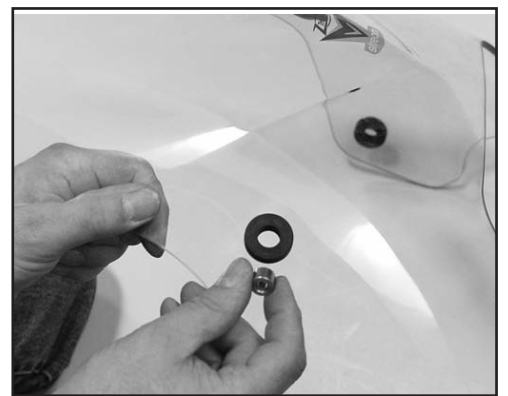



Figure 7

2. Place windshield on Brackets. Align Ball Socket on windshield with Ball Stud. With the side of your hand, give a firm tap (from the outside of the windshield) to seat the ball stud into the socket. Be certain the ball is fully seated in socket. **Figure 8**

 **Do not use Lubricants in the Ball Socket except saliva or water.**

3. Install windshield to brackets with a Flat Screw (4) and Cap (5). Secur with Cap Nuts (8). Firmly tighten hardware. **(3mm Hex Key) Figure 9**

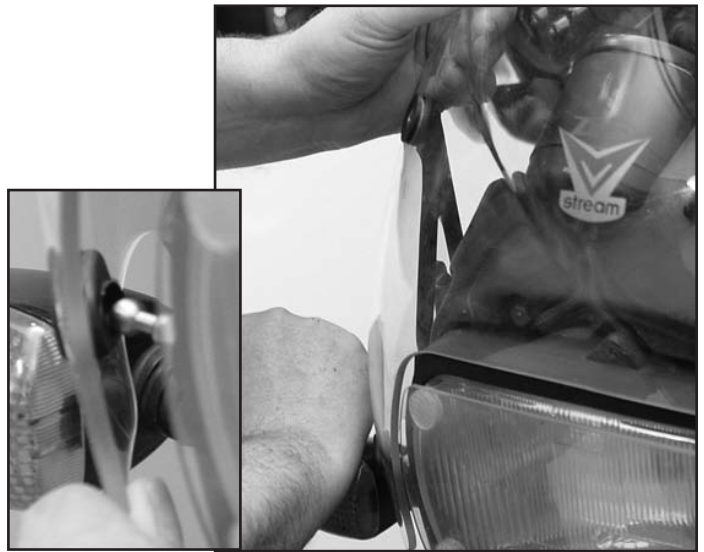

Figure 8

## MAINTENANCE

To clean the screen, wash with a clean soft cloth, plenty of warm water and if necessary, a non-abrasive soap such as dishwashing liquid. Flannel or soft chamois make good cleaning cloths. **Paint, glue residue or grease removal:** Moisten cotton with Naphtha or Turpentine followed by a wash as above. National Cycle Shield Wash™ makes a good daily cleaner and comes with a handy travel size bottle. N1401-01 Shield Wash is safe for helmet visors.

Do not clean polycarbonate in hot sun or high temperatures. Do not clean the screen with glass cleaners. Do not use rain protective products on the screen other than National Cycle brand Rain Zip® (Part No. N1410-01). Do not allow brake fluid, alcohol, or strong solvents to contact the screen.



Figure 9

## WARNING

Never ride your motorcycle with loose accessory mounting hardware. Check the hardware for tightness regularly.

Today's motorcycles are built with enough frame rigidity to withstand the moderate loads imposed on them by the foreseeable addition of an accessory(ies). If an accessory(ies) adversely affects your motorcycle's stability, immediately remove the accessory(ies). Do not ride a motorcycle that exhibits unsafe handling traits.

Have experienced service personnel correct any problem before riding with the accessory(ies) installed. For further questions concerning handling problems associated with an accessory(ies), contact your dealer, motorcycle manufacturer, or accessory manufacturer.



### ZTechnik 3-Year Limited Warranty

Register your windshield on Line at: [www.ZTechnik.com](http://www.ZTechnik.com)

ZTechnik hereby warrants to the original registered owner of a ZTechnik polycarbonate windshield for a period of three years from the date of purchase against breakage. This limited warranty is expressly limited to the replacement of the polycarbonate windscreen. This limited warranty does not include scratches, coating failure, cosmetic wear and tear, replacement of hardware, or any consequential damages or expenses including labor cost of installation, removal and/or replacement, inconvenience, inbound freight expenses or damage to any other component of the motorcycle or any other accessories. Certain chemicals, generally known as acidic hydrocarbons, are known to cause polycarbonate damage and will not be covered under this limited warranty. Please refer to the cleaning instructions supplied with all ZTechnik windshields.

Visit [www.ZTechnik.com](http://www.ZTechnik.com) for further details or call or write ZTechnik / PO Box 158 / Maywood, IL 60153 / 708-3430400