

TOOLS REQUIRED:

- Masking Tape
- Marking Pen
- Small Wood Block 1/2" Thick
- Power Drill with 7/32" Drill Bit
- 8mm Wrench
- No. 2 Phillips Screwdriver

PARTS LIST:

Part No.	Description	Qty.
70-710046F-000	Front of Front	1
70-710046R-000	Rear of Front	1

Bag No. 448

42-423050-000	Nut, M5	4
55-568216-000	Screw, M5-8 x 16	4
49-490531-000	Washer, Flat	4

PREPARATION:

1. Position motorcycle securely on its stand or a work stand.
2. Clean the fender thoroughly.

INSTALLATION

1. Cover the area of the fender where the Fender Tip goes with a thin layer of masking tape. Make certain the tape is smooth. **Figure 1.**
2. Carefully, position the front Fender Tip on the fender, make sure the Tip is centered on the fender. **Figure 2.**
3. Mark the hole locations with the marking pen. **Figure 3.**
4. Remove the Fender Tip.
5. Drill holes through the fender at the marks. **Due to close clearances between front fender and tire, place block of wood between the fender and the tire to avoid tire damage. Figure 4.**
6. Remove the masking tape.
7. Position the Fender Tip and insert the screws from the outside.
8. Install the washers and nuts on the screws and tighten securely. **Figure 5.**
9. Repeat the above steps to install 70-710046R Fender Tip to the rear of the front fender.

MAINTENANCE

Clean and polish with a chrome cleaner/polish. Check tightness of the nuts regularly.



Figure 1.



Figure 2.



Figure 3.



Figure 4.

Note: Hold the drill so the drill bit goes into the fender straight.

Wood Block

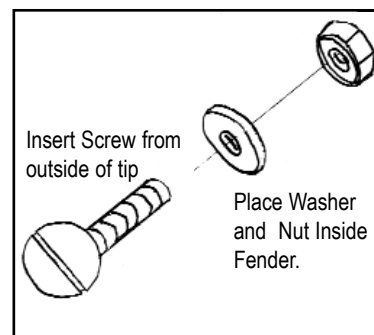

Figure 5.

INSTALLATION INSTRUCTION
CAST FENDER TIP for Honda VTX 1300 R
N7006 Rear Fender Tip

TOOLS REQUIRED:

- Masking Tape
- Marking Pen
- Power Drill with 7/32" Drill Bit
- 8mm Wrench
- No. 2 Phillips Screwdriver

PARTS LIST:

Part No.	Description	Qty.
70-710047-000	Rear of Rear	1
Bag No. 447		
42-423050-000	Nut, M5	2
55-568212-000	Screw, M5-8 x 12	2

PREPARATION:

1. Position motorcycle securely on its stand or a work stand.
2. Clean the fender thouroughly.

INSTALLATION

1. Cover the area of the fender where the Fender Tip goes with a thin layer of masking tape. Make certain the tape is smooth. **Figure 1.**
2. Carefully, position the Rear Fender Tip on the fender, make sure the Tip is centered on the fender. **Figure 1.**
3. Mark the hole locations with the marking pen. **Figure 1.**
4. Remove the Fender Tip.
5. Drill holes through the fender at the marks. **Figure 2.**
6. Remove the masking tape.
7. Position the Fender Tip and insert the screws from the outside.
8. Install the nuts on the screws and tighten securely. **Figure 3.**

MAINTENANCE

Clean and polish with a chrome cleaner/polish. Check tightness of the nuts regularly.



Figure 1. Tape Fender, Position Fender Tip, Mark Fender

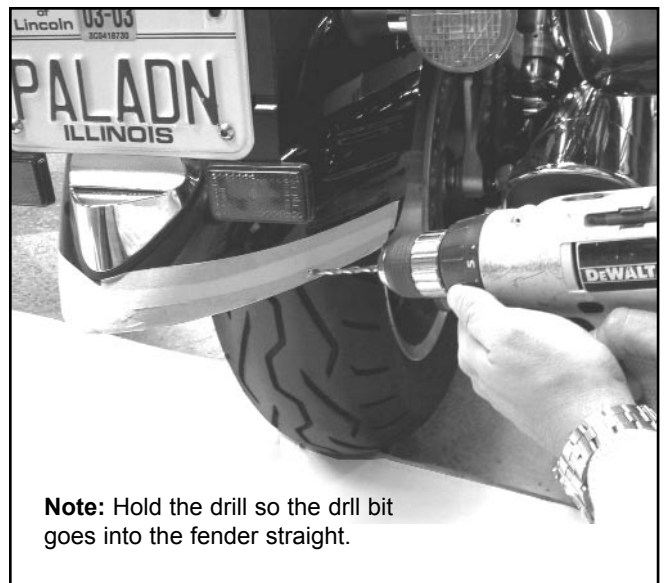

Figure 2.

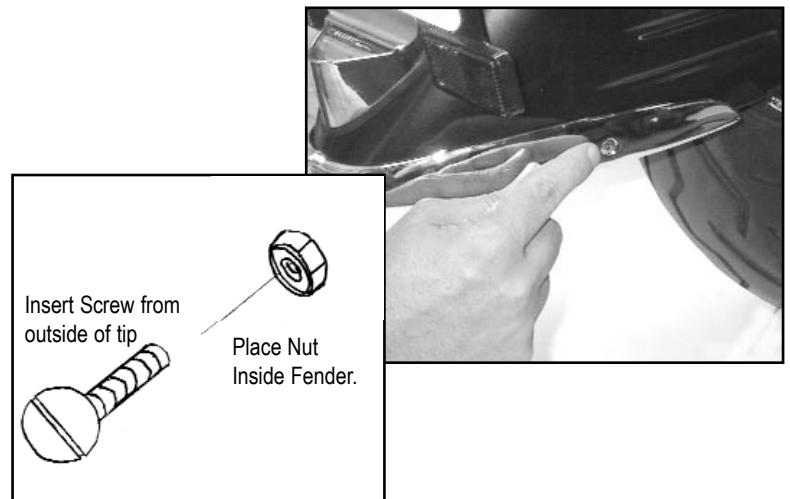

Figure 3.