

072447 Yamaha Tracer 900 & Tracer 900 GT Hugger Fitting Instructions

Kit Includes:

1X	C072447	Moulding
1X	CFK072447 & CFK072447B	Pair of Galvanised Brackets
2X	CBOL0220	M6 X 25mm Bolt
2X	CWAS0230	M6 Large Plastic Washer
2X	CSPA0004	10mm X 19mm X M6 Spacer
2X	CBOL0123	M6 X 12mm Bolt
2X	CNUT0200	M6 Nyloc Nut
2X	CWAS0221	M6 Small Plastic Washer
1X	CWAS0901	Rubber Washer

Note: Although not completely necessary, removing the rear wheel during fitment can help with access.

- Remove the OEM Hugger. The OEM nut and bolt from the right-hand side fixing of the OEM hugger are used again to attach the Pyramid Hugger - the steel collar from this mounting point is not used in the Pyramid Hugger assembly.
- Loosely fit the smaller of the two brackets on top of the existing OEM bracket on the bike. To do this remove the small bolt that secures the existing OEM bracket to the inside of the swingarm and refit with both the OEM bracket and smaller Pyramid bracket. Be sure to fit this in the same orientation as shown in the circular graphic below.
- Loosely fit the Pyramid Hugger as shown in the diagram below. The **M6 X 25mm Bolts & M6 Large Plastic Washers** go on top in the forward two mounting points, the **Larger Bracket** then fits beneath the Pyramid Hugger and the **10mm X 19mm X M6 Spacers** fit between the Larger Bracket and the Pyramid Hugger (the diagram below helps to visualise this).
- Refit the OEM bolt removed from the right-hand side - the **Rubber Washer** fits between the OEM Bracket and the Pyramid Hugger at this point. **Note:** It can help to position the nut in a spanner as shown in the GREY graphic below - this will allow for easier access around the back.
- Once the Pyramid Hugger is loosely fitted in the 3 original mounting points, the end of both **Brackets** can be attached using the **M6 X 12mm Bolts, M6 Nyloc Nuts & M6 Small Plastic Washers** supplied.
- All mounting points can be fully tightened once all are in place and have been fitted loosely.

Check all fixings periodically.

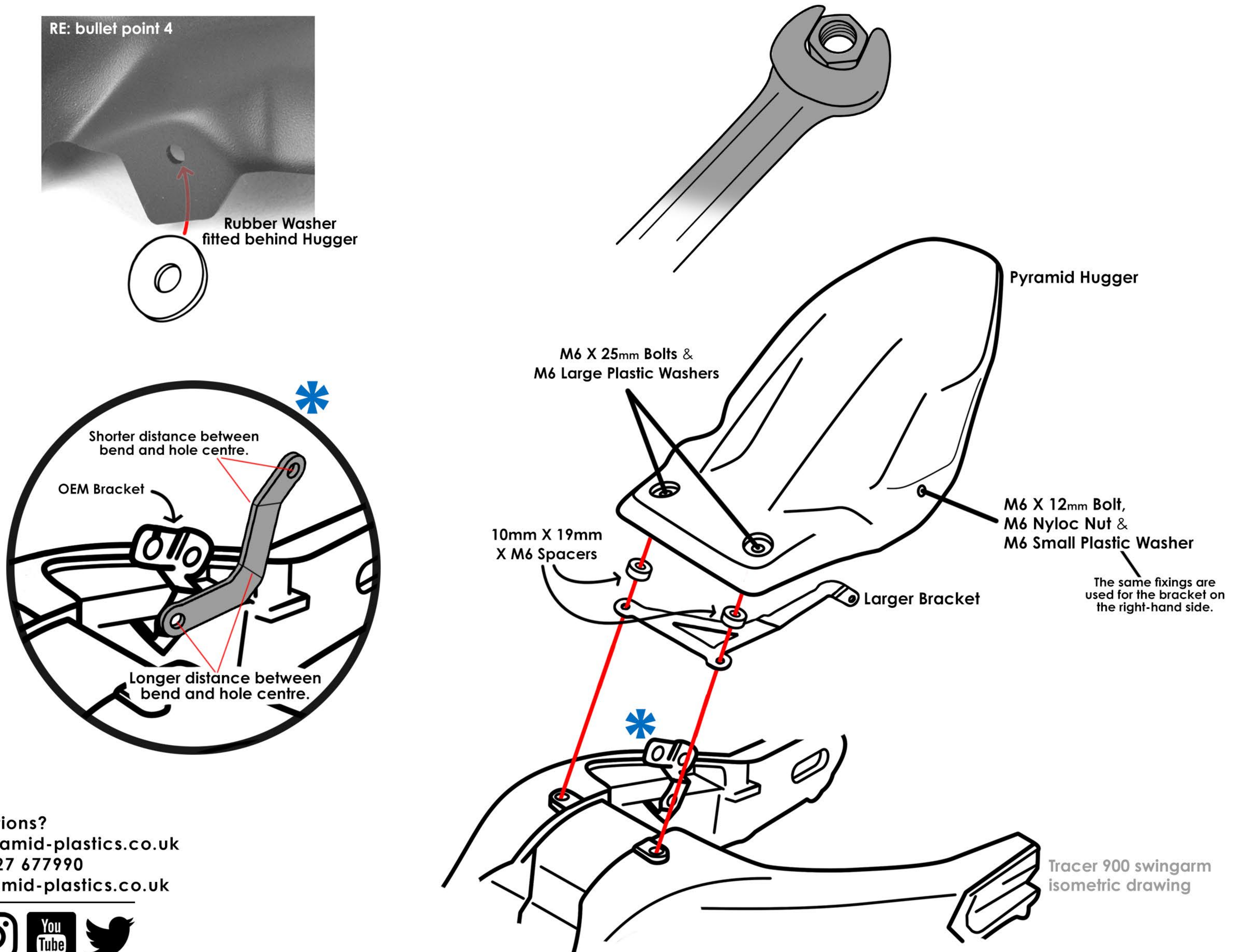

Any questions?
sales@pyramid-plastics.co.uk
 +44 (0)1427 677990
www.pyramid-plastics.co.uk



Follow us on social media and feel free to leave us a review!