

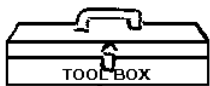

By National Cycle

PARTS LIST

Index	Part No.	Description	Qty.
1	90-970104-000	Highway Bar, Left	1
2	90-970105-000	Highway Bar, Right	1
BAG 458			
3	51-515720-000	Screw, M8 x 20	5
4	37-371590-000	Frame Bracket	2
5	51-513050-000	"U" Bolt	2
6	42-431010-000	Whizlock Nut, Chrome	4
7	49-495522-000	Spacer 3/16"	1
8	49-495527-000	Spacer 1/2"	1



- Ratchet Wrench
- Handle with 3/8" Drive
- 10, 12 and 14mm Sockets
- Hex Key, 6mm
- Wrench, 1/2"
- Torque Wrench
- Service Manual

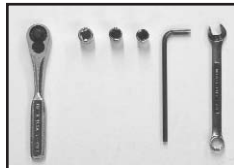

PREPARATION

1. Position the motorcycle securely on its stand or a work stand.

INSTALLATION

2. Remove the screw that secures the horn to its mounting bracket (socket, 12mm), the screw will not be re-used. **Figure 1.**

3. Place the 3/16" thick spacer between the tab and mounting bracket and secure the horn with a M8 x 20 Screw (Hex Key Wrench). Turn the horn so it points down but does not touch the motorcycle chassis. Tighten the Screw securely. **Figure 2.**

4. Remove the screw that holds the top of the radiator cover (socket, 10mm). Set the screw aside for re-use. **Figure 3.**



Figure 3

INSTALLATION AND OWNER'S MANUAL

P4008

for HONDA® VT 750 DC Spirit

NOTE: Right and Left side of Motorcycle is determined while sitting on the bike.

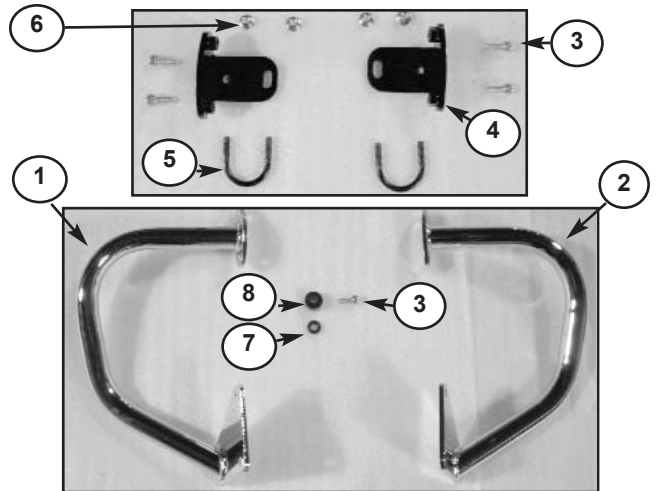

Parts List

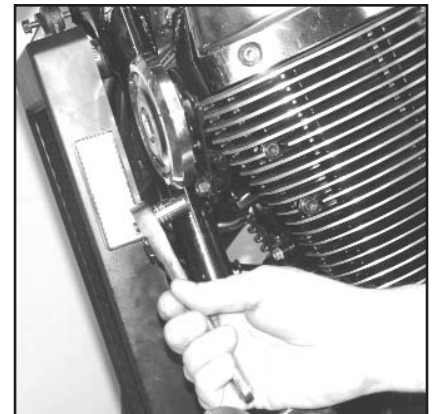

Figure 1

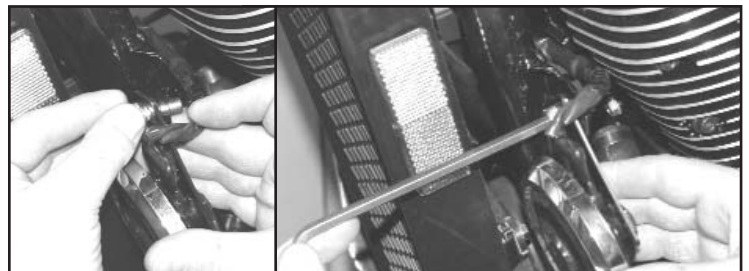

Figure 2

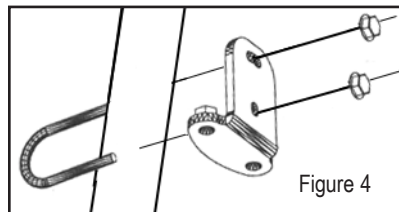

Figure 2

5. Position a U-bolt around the motorcycle chassis tube at the base of the cylinder head cover. **Figure 4.**

6. Position a Frame Bracket between the chassis tube and radiator.

7. Insert the U-bolt into the holes in the Frame Bracket, start 5/16-18 Nuts onto the ends of the U-bolt. **Figure 5.**



NOTE: Take notice and mark the orientation of the footbrake lever assembly. Maintaining this orientation is crucial during the highway bar assembly process.

8. Unscrew the bolts that hold the foot pegs to the motorcycle chassis (socket, 14mm). Leave the bolts in the foot peg bracket. **Figure 6.**

9. While holding the inner foot peg weldment away from the chassis, position the lower bracket on the Highway Bar between the weldment and the chassis. Thread the foot peg mounting bolts into the chassis. **Figure 7 and 8.**



Figure 6

Hold the inner foot peg weldment away from the chassis and position the lower bracket on the Highway Bar *between* the weldment and the chassis.



Figure 7



Figure 8



ATTENTION! While inserting the lower bracket of the highway bar into the right side footpeg assembly, take extra care to ensure the brake assembly does not move out of position.

10. Align the Frame Bracket with the upper bracket on the Highway Bar and start (2) M8 x 20 Screws through the Highway Bar and into the Frame Bracket (Hex Key Wrench.) **Figure 9.**



Figure 9

11. Tighten the foot peg bolts to 20 ft/lbs. **Figure 10.**

Tighten the M8 x 20 Screws to 10 ft/lbs. **Figure 11.**

Tighten the Nuts on the U-bolt evenly and tight. (wrench, 1/2")

12. Repeat the above process on the other side of the motorcycle.

13. Position the 1/2" thick spacer (item 8) between the radiator mounting tab and the motorcycle chassis. Using the original screw, attach the radiator and cover to the chassis. Tighten the screw to 6 ft/lbs. **Figure 12.**



Figure 10



Figure 11

8



Figure 12

MAINTENANCE / CAUTION

The high quality chrome finish of your National Cycle Chrome Highway Bar can be maintained with any quality chrome cleaner and / or polish applied with a soft cloth.

Check hardware for tightness regularly. Never ride with loose mounting hardware. Check to be sure your Highway Bar does not contact any part of the motorcycle at a full turn left and right. Correct any problem before using the motorcycle.