



Read these instructions carefully and thoroughly before beginning work. Dealers, if installing this windshield for a customer please give them this manual. It contains information needed to properly maintain and use this product.



### Attention:

Special notes and cautionary measures which can prevent damage to the accessory or motorcycle.



### Note:

Tips for facilitation of operation, control and adjustment, as well as maintenance work.



Figure 1

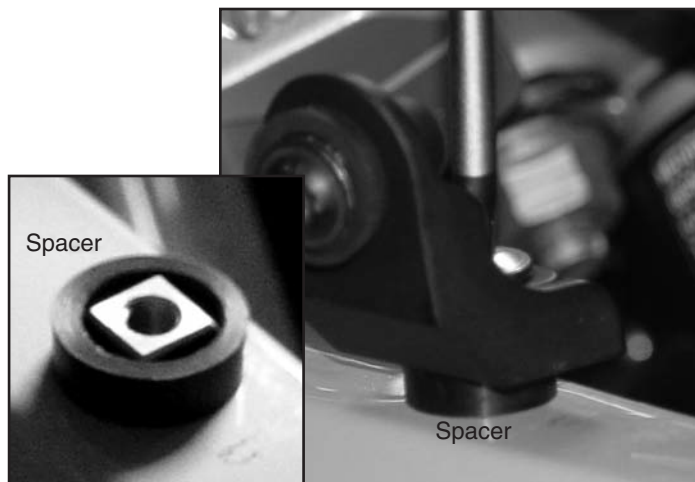

Figure 2

### CONTENTS OF KIT

Item	Description	Part No.	Qty.
1	VStream® Windshield		1
Bag #987			
2	Nylon Spacers	44-443520-000	2
3	Bushing, Top Hat	49-495671-000	2
4	Screw	51-515420-000	2
5	Washer, Flat	49-490453-000	2
6	Spacer	49-495552-000	6

### TOOL REQUIRED:

T-25 Torx

T-40 Torx

### PREPARATION



All stock hardware will be re-used.

1. Remove the stock windshield. **(T25 and T40 Torx)**
2. Remove the Windshield Swivel Mount point to expose square nut. **(T40) Figure 1**
3. Place Spacer from Bag #987 over nut. **Figure 2**
4. Reinstall Windshield Swivel Mount. **(T40) Figure 2**

VStream® windshield patent no. 7,387,328

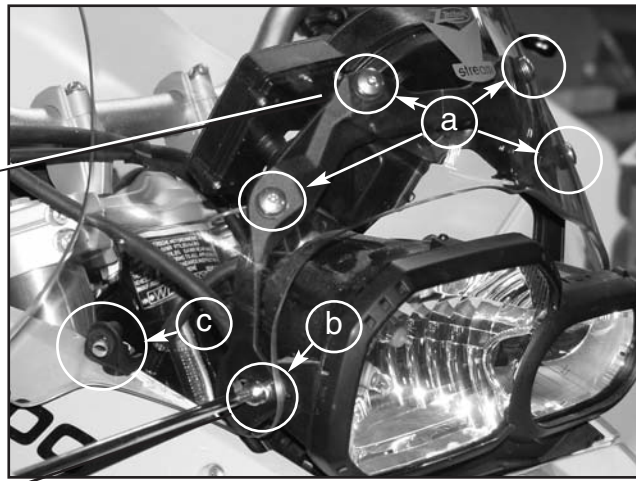
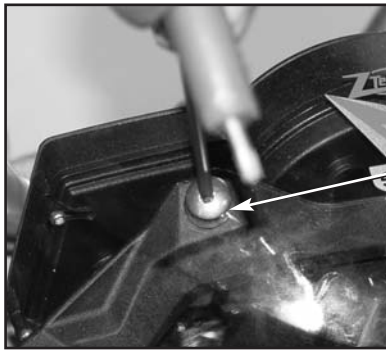

Figure 3

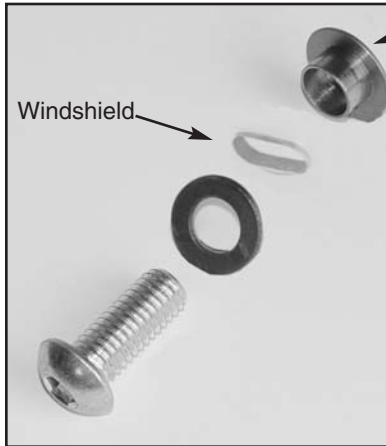

Figure 4



Figure 5



Figure 6

## INSTALLATION

1. Insert one spacer (6) into each of the round mount holes in the VStream windshield.
2. Place VStream Windshield on original mount points.
3. Loosely install the 4 upper screws (a). **(T25) Figure 3**
4. At point (b) assembly hardware as shown in **figure 4. (T25)**

From inside of windshield insert Top Hat Bushing (3) into hole with flat of Bushing against headlight housing.

Place Flat Washer (5) to outside of Windshield.

Loosely secure with Screw (4) supplied in Bag 987.

5. Loosely install the Swivel Mount Screw (c). **(T40) Figure 3**
6. Adjust Windshield. **Figure 5**
7. Tighten all hardware including the inside screw on the Swivel Mount Bracket. **(T25 and T40) Figure 6**

## MAINTENANCE

**Cleaning:** Wash with a clean soft cloth, plenty of warm water and, if necessary, a non-abrasive soap such as dish-washing liquid. Flannel or soft chamois make good cleaning cloths. Do not use rain protective products on the screen due to the solvent action of the alcohol in these products. Do not allow brake fluid, alcohol, or strong solvents to contact the screen.

National Cycle Windshield Wash Part number N1401 is recommended for everyday cleaning. Product is supplied with a handy travel size container and rag for easy storage on the motorcycle.

Ask your local dealer or visit: [www.ztechnik.com](http://www.ztechnik.com)